

MUTUAL OPERATIONS

PHYSICAL PROPERTY

Common Entry Walkways - Mutual Two Only

When two units are side-by-side and share a common entrance walkway and one shareholder wants to relocate their entry walkway, that shareholder must obtain permission, in writing, from the owner of the other affected adjacent unit.

The entrance for the adjacent unit shall be relocated at the sole expense of the shareholder whose unit is being altered to provide the minimum/maximum four feet six inches (4' 6"). The total width will include three-inch (3") buffers on each side if decorative stone is being used.

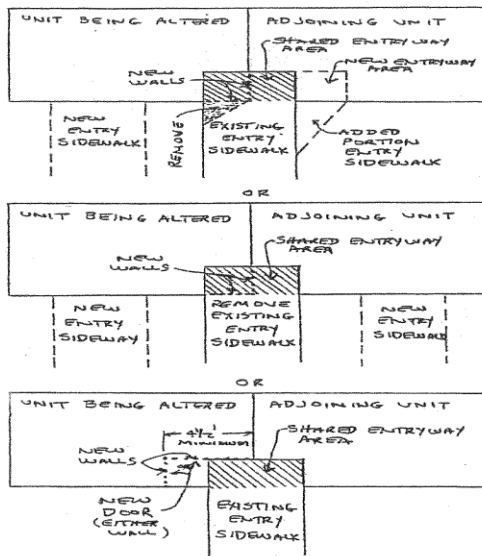

MUTUAL ADOPTION

Two: 27 Oct 11

AMENDMENTS

16 Apr 15

(Apr 15)