



Board of Directors

Agenda

Clubhouse Four
Tuesday, June 30, 2020, 1:00 p.m.
Via Live Stream

To view the live GRF Board meeting:

- Go to www.lwsb.com
- Click on the [Live GRF Board meeting](#) tab.
- The tab will be active at 12:45 pm on the day of the meeting
- The live streaming uses YouTube live and terminates at the close of the meeting

- 1) Call to Order/Pledge of Allegiance
- 2) Roll Call
- 3) President's Comments
 - a) Announcements
- 4) Shareholder/Member Comments
 - a) Written, submitted prior to meeting
 - b) Verbal, via live streaming

Note: Foundation Shareholder/Members are permitted to make comments before the meeting business of the Board begins. The Open Meeting Act allows boards of directors to establish reasonable time limits for the open forum and for speakers to address the board. ([Civ. Code §4925\(b\)](#).) Time limits, per speaker, are limited to:

- 4 - minute limit per speaker, when there are no more than 15 speakers
 - 3 – minute limit per speaker, 16 - 25 speakers
 - 2 – minute limit per speaker, over 26 speakers
- 5) New Business
 - a) General
 - i) Reserve and Capital Funding Requests – Replacement and Purchase of Fitness Center Equipment (Mrs. Perrotti, pp. 1-40)
 - ii) Approve Sale of Existing Fitness Center Equipment (Ms. Rapp, pp. 41-44)
 - iii) Approve Opening of Mission Park, Stage 1 – Pickleball, Under Required COVID-19 Guidelines (Mr. Friedman, pp. 45-47)
 - 6) Board Member Comments
 - 7) Next Meeting/Adjournment

Next regular GRF Board of Directors meeting, Tuesday, **July 28, 10:00 a.m.**, Clubhouse Four.

THIS
PAGE
LEFT
BLANK
INTENTIONALLY



Golden Rain Foundation

Golden Rain Foundation

Leisure World, Seal Beach

BOARD ACTION REQUEST

TO: GRF BOARD OF DIRECTORS
FROM: TERRY DE LEON, RECREATION DIRECTOR
SUBJECT: RESERVE AND CAPITAL FUNDING REQUESTS - FITNESS CENTER EQUIPMENT REPLACEMENT
DATE: JUNE 24, 2020
CC: FILE

At its June 9, 2020 meeting the Golden Rain Board of Directors approved Fitness Center Expansion, Phase 1 (Physical Changes and Interior Finishes). Phase 2 of the project is now being brought forth to the Board for the replacement and addition of the Fitness Centers equipment under the direction of a professional fitness consultant with equipment under full manufacturer's warranty and maintenance and inspection programs. The replacement of the equipment has been recognized by our insurance broker as:

"...As you are aware, Phly values Leisure World Seal Beach and its Boards proven and trusted professionalism in making improvements that continue to make Leisure World Seal Beach a safer place.

The proposed fitness center under the direction of a professional consultant and proposed replacement of the fitness equipment is another example of the many proactive measures the community continues to take in seeing Leisure World Seal Beach continues to be the most safe community in the nation.

As we have discussed, we are in a very challenging/hard insurance market with all policies under significant scrutiny!

This is a very important change and another example of the type improvements which have enabled Phly to continue to provide the absolute best policy renewal terms , conditions and lowest premiums possible..."

Three companies were solicited to provide quotes on the equipment list that was approved by the Fitness Equipment Review Committee members, bids were as follows (see Exhibits). The new equipment will provide the Fitness Center with updated and technologically advanced equipment fitting the unique and varied needs of the community membership.

1. Out- Fit	\$323,740.54
2. Precor Commercial Fitness	\$327,105.43
3. Commercial Fitness Equipment	\$341,209.65

All quotes include tax, shipping, and setup fees. Also included will be an equipment warranty and a service agreement.

Reserve Funding (replacement of existing equipment) of \$286,698.95 and Capital funding (additional equipment) of \$32,925.65 is requested (see Exhibits).

I move to approve the acceleration of Reserve funding, in the amount of \$286,699, and authorize Capital Funding, in the amount of \$37,042, for a total funding authorization of \$323,741 and authorize the Executive Director to initiate the purchase of fitness equipment, from Out-Fit fitness company, in the amount of \$323,740.54.

Out-Fit
 4590 Ish Drive
 Suite 100
 Simi Valley, CA 93063
 t. 800-376-3339

Date	Number
6/23/2020	38120
Prepared By:	
Chris Fisher (805) 320-6619 cfisher@out-fit.net	

Bill To				Ship To		
Leisure World Seal Beach 13533 Seal Beach Blvd Seal Beach CA 90740				Leisure World Seal Beach 13533 Seal Beach Blvd Seal Beach CA 90740		
Phone				Phone		
Payment Terms		Desired Delivery Date		Est. Lead Time		Sales Consultant
Payment upon Order		7/22/2020		6-8 Weeks		Chris Fisher
Qty	Vendor	Item	Description	List Price	Unit Price	Ext. Price
4	Precor USA	AMT733-P30	CARDIO Adaptive Motion Trainer - P30 LED Console	7,595.00	5,982.35	23,929.40
		- BP	(Black Pearl Frame)			
1	Core Health &	8 Series	8 Series Gauntlet w/LCD	7,599.00	5,764.71	5,764.71
		Gauntlet				
		w/LCD				
8	Precor USA	TRM731-P30	Treadmill - LED Motion Control Console, 0.5	7,545.00	5,717.65	45,741.20
		- BP	to 12 MPH, 0 to 15% Incline (Black Pearl			
			Frame)			
5	Scifit	REX7001	Scifit REX Total Body Recumbent Elliptical -	6,125.00	5,826.47	29,132.35
			Premium Seat, Foot Straps, Adapter			
7	Precor USA	RBK835-P30 -	Recumbent Cycle - P30 console (Black Pearl	4,335.00	3,126.47	21,885.29
		BP	Frame)			
3	Scifit	PRO2 -	SciFit Pro 2 Adj. Cranks, Adj. /Swivel Seat	5,590.00	5,292.65	15,877.95
		Premium Seat				
1	Precor USA	UBK835-P30 -	Upright Cycle - P30 console (Black Pearl	4,025.00	2,850.00	2,850.00
		BP	Frame)			
1	Scifit	PRO1000 -	Sci-Fit Pro 1000 with adjustable cranks and	5,060.00	4,752.94	4,752.94
		Premium Seat	Swivel Seat			
1	Lifecore	Assault AirBike	LifeCore Fitness Assault AirBike, Classic	799.00	757.14	757.14
1	Concept2, Inc.	2712-US	Concept 2 Rower - Model D with PM5	900.00	900.00	900.00
			Monitor - Black			
2		MISC ITEMS	ECHELON EX1 BIKE WITH ANNUAL	1,199.98	1,199.98	2,399.96

TOTAL PREFERRED CLIENT DISCOUNT \$61,284.87

Date	Number
6/23/2020	38120

Out-Fit
 4590 Ish Drive
 Suite 100
 Simi Valley, CA 93063
 t. 800-376-3339

Bill To			Ship To			
Leisure World Seal Beach 13533 Seal Beach Blvd Seal Beach CA 90740			Leisure World Seal Beach 13533 Seal Beach Blvd Seal Beach CA 90740			
Qty	Vendor	Item	Description	List Price	Unit Price	Ext. Price
SUBSCRIPTION PLAN						
LIFE FITNESS CIRCUIT						
1		MISC ITEMS	LF Circuit Series SC Ab Crunch	3,299.00	2,883.00	2,883.00
1		MISC ITEMS	LF Circuit Series SC Biceps Curl	3,299.00	2,883.00	2,883.00
1		MISC ITEMS	LF Circuit Series SC Chest Press	3,299.00	2,883.00	2,883.00
1		MISC ITEMS	LF Circuit Series SC Seated Leg Curl	3,299.00	2,883.00	2,883.00
1		MISC ITEMS	LF Circuit Series SC Leg Extension	3,299.00	2,883.00	2,883.00
1		MISC ITEMS	LF Circuit Series SC Lat Pulldown	3,299.00	2,883.00	2,883.00
1		MISC ITEMS	LF Circuit Series SC Seated Row	3,299.00	2,883.00	2,883.00
1		MISC ITEMS	LF Circuit Series SC Squat	3,299.00	2,883.00	2,883.00
1		MISC ITEMS	LF Circuit Series SC Shoulder Press	3,299.00	2,883.00	2,883.00
1		MISC ITEMS	LF Circuit Series SC Triceps Press	3,299.00	2,883.00	2,883.00
1		MISC ITEMS	LF Circuit Series Wheel Kit	155.00	111.00	111.00
1		MISC ITEMS	LF Circuit Series Transition Exercise Kits (40 Placards)	155.00	111.00	111.00
1		MISC ITEMS	LF Circuit Series Placard Stand	155.00	111.00	111.00
PRECOR STRENGTH						
1	Precor USA	FTS GLIDE	FTS Glide Functional Strength Trainer	4,045.00	2,977.94	2,977.94
1	Precor USA	DPL0802	Precor Discovery Plate-Loaded Smith Machine	4,450.00	3,600.00	3,600.00
1	Precor USA	DSL404	Precor Discovery Selectorized Chest Press	4,250.00	3,438.24	3,438.24
1	Precor USA	DSL304	Precor Discovery Selectorized Lat Pulldown	4,550.00	3,680.88	3,680.88
1	Precor USA	DSL505	Precor Discovery Selectorized Rear Delt/Pec Fly	4,950.00	4,004.41	4,004.41

Date	Number
6/23/2020	38120

Out-Fit
 4590 Ish Drive
 Suite 100
 Simi Valley, CA 93063
 t. 800-376-3339

Bill To	Ship To
Leisure World Seal Beach 13533 Seal Beach Blvd Seal Beach CA 90740	Leisure World Seal Beach 13533 Seal Beach Blvd Seal Beach CA 90740

Qty	Vendor	Item	Description	List Price	Unit Price	Ext. Price
1	Precor USA	DSL310	Precor Discovery Selectorized Seated Row	4,250.00	3,438.24	3,438.24
1	Precor USA	DSL602	Precor Discovery Selectorized Leg Press	6,500.00	5,257.35	5,257.35
1	Precor USA	DSL605	Precor Discovery Selectorized Leg Extension	4,950.00	4,004.41	4,004.41
1	Precor USA	DSL619	Precor Discovery Selectorized Seated Leg Curl	5,750.00	5,073.53	5,073.53
1	Precor USA	C008ES	Inner / Outer Thigh	3,600.00	2,647.06	2,647.06
1	Precor USA	DSL313	Precor Discovery Selectorized Back Extension	4,250.00	3,438.24	3,438.24
1	Precor USA	DSL714	Precor Discovery Selectorized Abdominal	4,750.00	3,880.88	3,880.88
1	Precor USA	DSL315	Precor Discovery Selectorized Rotary Torso	4,850.00	3,923.53	3,923.53
1	Precor USA	302-250	Longpull w/Shroud, 250lbs	3,875.00	3,132.35	3,132.35
1	Precor USA	304-250	Pulldown w/Shroud, 250lbs	3,700.00	2,992.65	2,992.65
FREEWEIGHTS						
1	Precor USA	DBR814	Discovery Series Dumbbell Rack, 3-Tier, 10 Pair	1,090.00	857.14	857.14
1	Out-Fit	OF-UDB550	5-50lb Urethane Pro Style Dumbbell Set	1,695.00	1,214.29	1,214.29
1	Precor USA	DBR815	Discovery Series Dumbbell Rack, 3-Tier, 15 Pair	1,505.00	1,181.43	1,181.43
1	Out-Fit	OF-UDB550	5-50lb Urethane Pro Style Dumbbell Set	1,695.00	1,214.29	1,214.29
1	Out-Fit	OF-UDB55-75	55-75lb Urethane Pro Style Dumbbell Set	1,695.00	1,497.91	1,497.91
4	Precor USA	DBR119	Discovery Series Multi-Adjustable Bench	1,200.00	937.14	3,748.56
1	Precor USA	DBR113	Discovery Series Adjustable Decline Bench	1,090.00	857.14	857.14
1	Precor USA	DBR116	Discovery Series Multi-Purpose Bench	560.00	440.00	440.00
1	Precor USA	DBR312	Discovery Series Back Extension	1,140.00	895.71	895.71
1	Precor USA	DBR702	Discovery Series Vertical Knee Up	1,230.00	967.14	967.14



Quote

Date	Number
6/23/2020	38120

Out-Fit
4590 Ish Drive
Suite 100
Simi Valley, CA 93063
t. 800-376-3339

Bill To			Ship To			
Leisure World Seal Beach 13533 Seal Beach Blvd Seal Beach CA 90740			Leisure World Seal Beach 13533 Seal Beach Blvd Seal Beach CA 90740			
Qty	Vendor	Item	Description	List Price	Unit Price	Ext. Price
1	Precor USA	ABX100S	ABX100 Ab Bench (Gloss Metallic Silver Frame w/Black Upholstery)	1,350.00	1,061.43	1,061.43
1	Precor USA	DPL601	Precor Discovery Series Plate-Loaded Angled Leg Press	5,550.00	4,361.43	4,361.43
1	Precor USA	DBR202	Discovery Series Preacher Curl Bench	1,030.00	810.00	810.00
1	Fitness Prod...	FPD-OB-47C	Light Commercial EZ Curl Bar	67.00	47.86	47.86
1	Precor USA	DPL540	Precor Discovery Plate-Loaded Chest Press	2,840.00	2,232.86	2,232.86
10	Fitness Prod...	FPD-RGP-2.5	Rubber Grip Plate 2.5lb	5.62	3.21	32.10
10	Fitness Prod...	FPD-RGP-5	Rubber Grip Plate 5lb	11.25	6.43	64.30
10	Fitness Prod...	FPD-RGP-25	Rubber Grip Plate 25lb	56.25	32.14	321.40
10	Fitness Prod...	FPD-RGP-35	Rubber Grip Plate 35lb	78.75	45.00	450.00
10	Fitness Prod...	FPD-RGP-45	Rubber Grip Plate 45lb	101.25	57.86	578.60
1	Everlast	4813BDTC	Everlast Heavy Bag/Speed Bag Stand	129.00	129.00	129.00
1	Everlast	4241	Everlast Leather Speed Bag - 9" x 6" (M)	34.99	34.99	34.99
1	Escape Fitne...	OHHW011	Single Hit Hub Wall Type 1	5,900.00	4,804.29	4,804.29
			Octagon 2 leg frame with 3 Equipment Shelves and the following attachments included:			
			Wing, 2 x Holster, 2 x Claw			
1	Out-Fit	OF-MB6-B	6lb Black Rubber Medicine Ball	32.95	22.86	22.86
1	Out-Fit	OF-MB8-B	8lb Black Rubber Medicine Ball	38.95	25.71	25.71
1	Out-Fit	OF-MB10-B	10lb Black Rubber Medicine Ball	42.95	28.57	28.57
1	Out-Fit	OF-MB12-B	12lb Black Rubber Medicine Ball	48.95	31.43	31.43
1	Out-Fit	OF-KB4	8.8lb/4kg White Kettlebell	15.95	12.86	12.86
1	Out-Fit	OF-KB6	13.2lb/6kg Dark Blue Kettlebell	24.95	19.29	19.29
1	Out-Fit	OF-KB8	17.6lb/8kg Pink Kettlebell	36.95	25.00	25.00



Quote

Date	Number
6/23/2020	38120

Out-Fit
4590 Ish Drive
Suite 100
Simi Valley, CA 93063
t. 800-376-3339

Bill To	Ship To
Leisure World Seal Beach 13533 Seal Beach Blvd Seal Beach CA 90740	Leisure World Seal Beach 13533 Seal Beach Blvd Seal Beach CA 90740

Qty	Vendor	Item	Description	List Price	Unit Price	Ext. Price
1	Out-Fit	OF-KB12	26.4lb/12kg Light Blue Kettlebell	49.95	42.14	42.14
1	Out-Fit	OF-KB16	35.2lb/16kg Yellow Kettlebell	70.00	50.00	50.00
1	Out-Fit	OF-KB20	44.09lb/20kg Purple Kettlebell	80.00	57.14	57.14
1	Out-Fit	OF-SB10	10lb Black Slam Ball	19.95	14.29	14.29
1	Out-Fit	OF-SB15	15lb Black Slam Ball	29.95	21.43	21.43
1	Out-Fit	OF-SB20	20lb Black Slam Ball	39.95	28.57	28.57
1	Out-Fit	OF-SB25	25lb Black Slam Ball	49.95	35.71	35.71
1	Fitness Prod...	FPD-1200	7' Olympic Bar	175.00	142.86	142.86
2	Out-Fit	OF-ROLLER-B LK	Foam Roller, Black. 35 inches	35.00	22.86	45.72
2	Fitness Anyw...	TRXCLUB4	Commercial Suspension Trainer (rubber handles, locking carabiner)	209.95	179.96	359.92
1	Fitness Prod...	FPD-BR-30FT	Battle Rope 30FT	99.99	77.14	77.14
1	Escape Fitne...	ECB050V3	5kg/11lbs Corebag - Green	92.00	74.91	74.91
1	Escape Fitne...	ECB100V3	10kg/22lbs Corebag - Blue	97.50	79.40	79.40
1	Escape Fitne...	ECB150V3	15kg/33lbs Corebag - Red	104.50	85.10	85.10
2		MISC ITEMS	ECHELON MIRROR ECHELON REFLECT - Echelon Reflect 50" - 12 Month Subscription	1,999.98	1,999.98	3,999.96
1		IDA	Installation, Delivery and Assembly *Includes Escape Single Hub bolt down**	15,985.00	15,985.00	15,985.00

Seal Beach Sales Tax 8.75% = \$25,171.67

Subtotal	287,710.53
Freight (From Factory)	10,855.34
Tax (8.75%)	21,050.73
Total	\$319,622.60

Quote expires 30 days from the Quote date. Customer's signature and payment per terms above required to process order unless otherwise specified. Buyer agrees to prices, specifications, standard terms & conditions of sale. Out-Fit's standard terms and conditions can be viewed at <http://bit.ly/outfitTOS>. All orders are to be treated as custom and made to order. All orders are FOB from Out-Fit's facility. Freight, Delivery and Installation quotes are estimates and are subject to change as a result of a site survey. Additional fees may apply.

Signature _____ Date _____
Print Name _____ Title _____

Total
\$ 323,740.54

Date	Proposal #
6/23/2020	34731
Prepared By:	
Betsy Jasny bjasny@precorcf.com (415) 722-5895	

Remit To:
Pacific Fitness Products LLC
12326 Beverly Park Rd #101
Lynnwood WA 98087-1506
425.338.2008, Fax 425.338.3538
orders@precorcf.com

Page 1 of 4

Bill To			Ship To	
Leisure World Seal Beach 13533 Seal Beach Blvd Seal Beach CA 90740 United States			Leisure World Seal Beach 13533 Seal Beach Blvd Seal Beach CA 90740 United States	
Order Primary Contact			On-Site Point of Contact	
Proposal Expires	Terms	PO #	Ship Method	Delivery Date
9/21/2020	Pynt w/order		Dealer Partner	8/14/2020

Qty	Item	Description	List Price	Our Price	Amount	Tax
4	EPRCMT-733-P31-BP	Precor Experience 733 Adaptive Motion Trainer - FIXED Height w/ P31 Console w/ Advanced LED Display, Black Pearl Frame	7,595.00	6,104.69	24,418.76	Yes
1	ESM-9-5270-8G-LCD	StairMaster Gauntlet (8 Series) w/LCD Screen	7,599.00	5,967.19	5,967.19	Yes
8	EPRCTRM-731-P31-BP	Precor Experience 731 Treadmill w/ P31 Console w/ Advanced LED Display, Black Pearl Frame	7,545.00	5,781.25	46,250.00	Yes
5	ESF-REX7001-INT	SciFit REX Total Body Recumbent Elliptical with Premium seat, foot straps, AC adapter included	6,015.00	6,040.00	30,200.00	Yes
7	EPRCRBK-835-P31-BP	Precor Experience 835 Recumbent Cycle w/ P31 Console w/ Advanced LED Display, Black Pearl Frame	4,335.00	3,132.81	21,929.67	Yes
1	ESF-PRO230-INT	SciFit Pro 2 Total Body exercise w/step thru seating. Adj cranks and swivel seat.	5,695.00	5,483.33	5,483.33	Yes
1	EPRCUBK-835-P31-BP	Precor Experience 835 Upright Cycle w/ P31 Console w/ Advanced LED Display, Black Pearl Frame	4,025.00	2,842.19	2,842.19	Yes
1	ESF-PRO100-INT	SciFit Pro 1 upper body w/adj head, cranks, swivel seat. Includes Wheelchair platform.	5,650.00	5,082.81	5,082.81	Yes
1	EPRCABK-865	Precor 865 Assault AirBike Elite w/Console	1,299.00	1,299.00	1,299.00	Yes
1	ECNConcept2-Row-D/PM5-B	Concept 2 Rower, Model D with PM5 Monitor - BLACK	1,095.00	1,095.00	1,095.00	Yes
2	EEF-ECHEx-5s	Echelon Fitness Connect EX5s Bike with 22" Touchscreen Display	1,999.00	1,484.38	2,968.76	Yes
2	EEF-1YRSUB	Echelon Fitness 1-Year Commercial Subscription: Includes Standard Warranty: 2 Yrs Parts ; 2 Yrs Labor Life Fitness Circuit	699.00	699.00	1,398.00	Yes
1	EEMisc.	LF Circuit Series SC Ab Crunch		0.00	3,099.00	Yes
1	EEMisc.	LF Circuit Series SC Bicep Curl		0.00	3,099.00	Yes
1	EEMisc.	LF Circuit Series SC Chest Press		0.00	3,099.00	Yes
1	EEMisc.	LF Circuit Series SC Seated Leg Curl		0.00	3,099.00	Yes
1	EEMisc.	LF Circuit Series SC Leg Extension		0.00	3,099.00	Yes
1	EEMisc.	LF Circuit Series SC Lat Pulldown		0.00	3,099.00	Yes
1	EEMisc.	LF Circuit Series SC Seated Row		0.00	3,099.00	Yes
1	EEMisc.	LF Circuit Series SC Squat		0.00	3,099.00	Yes
1	EEMisc.	LF Circuit Series SC Shoulder Press		0.00	3,099.00	Yes
1	EEMisc.	LF Circuit Series SC Triceps Press		0.00	3,099.00	Yes

Remit To:
Pacific Fitness Products LLC
12326 Beverly Park Rd #101
Lynnwood WA 98087-1506
425.338.2008, Fax 425.338.3538
orders@precorcf.com

Date	Proposal #
6/23/2020	34731
Prepared By:	
Betsy Jasny bjasny@precorcf.com (415) 722-5895	

Page 2 of 4

Qty	Item	Description	List Price	Our Price	Amount	Tax
1	EEMisc.	LF Circuit Series Wheel Kit		0.00	165.00	Yes
1	EEMisc.	LF Circuit Series Transition Exercise Kits (40 Placards)		0.00	165.00	Yes
1	EEMisc.	LF Circuit Series Placard Stand		0.00	165.00	Yes
		PRECOR STRENGTH				
1	EPICWFTSGlide	Precor Icarian FTS Glide Functional Strength Trainer. Two 200lb wt stacks. Titanium Frame	4,045.00	3,132.81	3,132.81	Yes
1	EPIC-D-802DPL	Precor Discovery PL Smith Machine Model 802	4,450.00	3,785.94	3,785.94	Yes
1	EPIC-D-404DSL	Precor Discovery Selectorized Chest Press Model 404	4,250.00	3,653.13	3,653.13	Yes
1	EPIC-D-304DSL	Precor Discovery Selectorized Lat Pulldown Model 304	4,550.00	3,910.94	3,910.94	Yes
1	EPIC-D-505DSL	Precor Discovery Selectorized Rear Delt/Pec Fly Model 505	4,950.00	4,254.69	4,254.69	Yes
1	EPIC-D-310DSL	Precor Discovery Selectorized Seated Row Model 310	4,250.00	3,653.13	3,653.13	Yes
1	EPIC-D-602DSL	Precor Discovery Selectorized Leg Press Model 602 Weight Stack 400 lbs / 182 kg	6,500.00	5,585.94	5,585.94	Yes
1	EPIC-D-605DSL	Precor Discovery Selectorized Leg Extension Model 605	4,950.00	4,254.69	4,254.69	Yes
1	EPIC-D-619DSL	Precor Discovery Selectorized Seated Leg Curl Model 619	5,750.00	5,390.63	5,390.63	Yes
1	EPIC-S-C008ES	Precor Vitality S-Line Inner/Outer Thigh. 170lb	3,600.00	2,784.38	2,784.38	Yes
1	EPIC-D-313DSL	Precor Discovery Selectorized Back Extension Model 313	4,250.00	3,653.13	3,653.13	Yes
1	EPIC-D-714DSL	Precor Discovery Selectorized Abdominal Model 714	4,750.00	4,123.44	4,123.44	Yes
1	EPIC-D-315DSL	Precor Discovery Selectorized Rotary Torso Model 315	4,850.00	4,168.75	4,168.75	Yes
1	EPICW302	Precor Icarian Longpull w/shroud. 250lbs.	3,875.00	3,295.31	3,295.31	Yes
1	EPICW304	Precor Icarian Pulldown w/shroud. 250lbs.	3,700.00	3,148.44	3,148.44	Yes
		FREEWEIGHTS				
1	EPIC-D-814DBR	Precor Discovery Dumbbell Rack. 3-Tier, 10 Pair. Saddled for Pro-Style DB	1,090.00	928.13	928.13	Yes
1	EESC-PAA575	Escape Fitness Rubber Dumbbell Set 5-75lbs	2,990.00	2,840.50	2,840.50	Yes
4	EPIC-D-119DBR	Precor Discovery Multi-Adjustable Bench Model 119	1,200.00	1,015.63	4,062.52	Yes

Date	Proposal #
6/23/2020	34731
Prepared By:	
Betsy Jasny bjasny@precorcf.com (415) 722-5895	

Remit To:
Pacific Fitness Products LLC
12326 Beverly Park Rd #101
Lynnwood WA 98087-1506
425.338.2008, Fax 425.338.3538
orders@precorcf.com

Page 3 of 4

Qty	Item	Description	List Price	Our Price	Amount	Tax
1	EPIC-D-113DBR	Precor Discovery Adjustable Decline Bench Model 113	1,090.00	928.13	928.13	Yes
1	EPIC-D-312DBR	Precor Discovery Back Extension Model 312	1,140.00	970.31	970.31	Yes
1	EPIC-D-702DBR	Precor Discovery Vertical Knee Up Model 702	1,230.00	1,046.88	1,046.88	Yes
1	EPICWABX100-GMS	Precor Icarian AbX Abdominal Bench w/ Black Upholstery, Gloss Metallic Silver Frame	1,350.00	1,148.44	1,148.44	Yes
1	EPIC-D-601DPL	Precor Discovery PL Angled Leg Press Model 601	5,550.00	4,721.88	4,721.88	Yes
1	EPIC-D-202DBR	Precor Discovery Preacher Curl Bench Model 202	1,030.00	876.56	876.56	Yes
1	EHAM-ATT-BAR-28-CURL-R	Hampton Fitness Revolving Chrome Curl Bar with Urethane Ergo Grips - 28"	66.00	54.69	54.69	Yes
1	EHAM-IB-86-7CE	Hampton Fitness 7' International Needle Bearing Bar with Hard Chrome (700lb Tested, 30 mm, 135,00 psi Rating)	200.00	164.06	164.06	Yes
1	EPIC-D-540DPL	Precor Discovery PL Chest Press Model 540	2,840.00	2,417.19	2,417.19	Yes
10	EHAM-HOG-R-2.5	Hampton Fitness Encased Rubber Coated International Grip Plate - 2.5lb	7.00	5.75	57.50	Yes
10	EHAM-HOG-R-5	Hampton Fitness Encased Rubber Coated International Grip Plate with Five Grips - 5lb	14.00	11.48	114.80	Yes
10	EHAM-HOG-R-25	Hampton Fitness Encased Rubber Coated International Grip Plate with Five Grips - 25lb	70.00	57.42	574.20	Yes
10	EHAM-HOG-R-35	Hampton Fitness Encased Rubber Coated International Grip Plate with Five Grips - 35lb	98.00	80.39	803.90	Yes
10	EHAM-HOG-R-45	Hampton Fitness Encased Rubber Coated International Grip Plate with Five Grips - 45lb	126.00	103.36	1,033.60	Yes
1	EE-220901	Everlast Kangaroo Leather Speed Bag, Black, 9" x 6"	69.99	54.69	54.69	Yes
1	EE-P00001608	Everlast Speed Bag Platform, Black	249.99	351.56	351.56	Yes
1	EESC-OHHW011	Escape Fitness Single Hit Hub Wall Type 1 Octagon 2 leg frame with 3 Equipment Shelves and the following attachments included: Torso Trainer, Wing, Holster, 2 x Claw, Battle Rope Eye	5,900.00	5,254.69	5,254.69	Yes
1	EAE-35131	Aeromat Dual Grip Power Medicine Ball 9" Diameter 6lb (Black/Red)	48.99	37.89	37.89	Yes
1	EAE-35132	Aeromat Dual Grip Power Medicine Ball 9" Diameter 8lb (Black/Orange)	53.99	42.19	42.19	Yes
1	EAE-35133	Aeromat Dual Grip Power Medicine Ball 9" Diameter 10 lb (Black/Yellow)	59.99	46.48	46.48	Yes
1	EAE-35134	Aeromat Dual Grip Power Medicine Ball 9" Diameter 12 lb (Black/Teal)	66.99	52.34	52.34	Yes
1	EBS-KBV08	Body-Solid Vinyl Kettlebell, 8lb	17.60	13.75	13.75	Yes
1	EBS-KBV12	Body-Solid Vinyl Kettlebell, 12lb	26.40	20.63	20.63	Yes
1	EBS-KBV15	Body-Solid Vinyl Kettlebell, 15lb	33.00	25.78	25.78	Yes
1	EBS-KBV20	Body-Solid Vinyl Kettlebell, 20lb	44.00	34.38	34.38	Yes
1	EBS-KBV25	Body-Solid Vinyl Kettlebell, 25lb	55.00	42.97	42.97	Yes
1	EBS-KBV30	Body-Solid Vinyl Kettlebell, 30lb	66.00	51.56	51.56	Yes
1	EFA-EXEM-SLAM-10	TRX SlamBall 10 lb	29.95	28.08	28.08	Yes
1	EFA-EXEM-SLAM-15	TRX SlamBall 15 lb	34.95	32.77	32.77	Yes



Proposal

Remit To:
Pacific Fitness Products LLC
12326 Beverly Park Rd #101
Lynnwood WA 98087-1506
425.338.2008, Fax 425.338.3538
orders@precorcf.com

Date	Proposal #
6/23/2020	34731
Prepared By:	
Betsy Jasny bjasny@precorcf.com (415) 722-5895	

Page 4 of 4

Qty	Item	Description	List Price	Our Price	Amount	Tax
1	EFA-EXEM-SLAM-20	TRX SlamBall 20 lb	39.95	37.45	37.45	Yes
1	EFA-EXEM-SLAM-25	TRX SlamBall 25 lb	44.95	42.14	42.14	Yes
1	EHAM-IB-86-7CE	Hampton Fitness 7' International Needle Bearing Bar with Hard Chrome (700lb Tested, 30 mm, 135,00 psi Rating)	200.00	164.06	164.06	Yes
2	EAE-33870	Aeromat Elite High Density Foam Roller 6" Diameter x 36", Firm (Black)	28.99	22.27	44.54	Yes
2	EFA-TRXCLUB4	TRX Club 4 Commercial Suspension Trainer (rubber handles, locking carabiner)	209.95	196.83	393.66	Yes
1	EHAM-HBR-30-S	Hampton Fitness Battle Rope, 2 Handles WITH Protective Sheaths (1.5 inches x 30 feet), 1 each	180.00	140.63	140.63	Yes
1	EESC-ECB050V3	Escape Fitness 5kg/11lbs Corebag - Green	92.00	81.94	81.94	Yes
1	EESC-ECB100V3	Escape Fitness 10kg/22lbs Corebag - Blue	97.50	86.84	86.84	Yes
1	EESC-ECB150V3	Escape Fitness 15kg/33lbs Corebag - Red	104.50	93.08	93.08	Yes
		Echelon Mirror Reflect				
1	EEF-ECHREFLO2	Echelon Fitness Reflect 50" Touchscreen	1,999.00	1,999.00	1,999.00	Yes
1	EEF-1YRSUB	Echelon Fitness 1-Year Commercial Subscription: Includes Standard Warranty: 2 Yrs Parts ; 2 Yrs Labor	699.00	699.00	699.00	Yes
1	Shipping, Del & Setup	Incoming Freight, Delivery and Setup Charges		28,956.00	28,956.00	Yes

Additional Notes:		
This Proposal along with the Terms & Conditions of Sale is Authorized on - Date: _____		
Authorized Signature: _____ Print Name: _____		
Prices reflect payment via check. Credit Card payment accepted for your convenience at an additional 3%. PCF is independently owned & operated by Pacific Fitness Products LLC, under license from Precor Inc.		
	Subtotal Tax (AVATAX 8.75%) Total	\$300,786.45 \$26,318.98 \$327,105.43

PACIFIC FITNESS PRODUCTS LLC

STANDARD TERMS & CONDITIONS

1. AGREEMENT: The terms and conditions of sale shall constitute a Sale Agreement between Pacific Fitness Products LLC. (hereinafter referred to as PFP) and Customer for all products and services to be provided by PFP to Customer, and no other terms and conditions and no modifications or amendments thereof shall be binding upon the parties unless consented in writing by PFP. Customer will review and sign a Sales Proposal to initiate orders for products and services, however any terms and conditions on such form which are in addition to or inconsistent with the terms and conditions of this Agreement shall be deemed to have been stricken for such orders.

2. DELIVERY: PFP will use its best efforts in the ordinary course of its business to effect deliveries as specified, however in no event, shall PFP be liable for any damages, consequential or otherwise, arising from any failure of PFP to meet any delivery date. Unless otherwise requested by Customer, delivery will be made by PFP's Delivery Team or an authorized 3rd Party Delivery Company selected by PFP or in the case of drop ship orders, a common carrier selected by PFP. Delivery of equipment will take place only if the original sales proposal has been signed by an authorized representative of Customer. Customer agrees to accept delivery of goods on an agreed upon date or within 20 days of when PFP has received all goods necessary to fulfill Customer's order from the manufacturer(s). In the event customer is unable or unwilling to accept installation within the time frame agreed upon above, customer agrees to arrange to store goods and remit payment as per the terms of this agreement. If PFP is willing to provide assistance in storage of equipment, the same shall be stored at prevailing market rates. PFP will make its best effort to accommodate customer's needs once a new timetable for delivery is established, however cannot guarantee reschedule date availability. In no event will PFP be liable for any loss, damage, or expense due to late delivery or damage caused by contracted delivery companies or carriers. Customer's notice of delivery schedule cancellation must be received by PFP no less than Fifteen (15) days prior to the confirmed delivery date and time. If the delivery cancellation is not received within that timeframe, the customer could be charged 20% of the total order, plus applicable storage fees.

3. PARTIAL SHIPMENT: PFP reserves the right to make partial shipments of products ordered by Customer as such products become available for shipment and may invoice separately for each shipment. Partial shipment of products shall not relieve Customer from Customer's obligation hereunder to accept shipments of the remainder of the order.

4. RISK OF LOSS: Title and risk of loss shall pass to Customer upon PFP's delivery of the equipment to a common carrier, authorized 3rd party delivery firm or to Customer

5. PAYMENT: Unless otherwise indicated, the terms of payment are as they appear on the signed sales proposal and or sales order documents. PFP reserves the right to require full or partial payment in advance of all or any part of the purchase price of any product or service listed on accepted proposal/order. PFP shall invoice Customer for the purchase price of each of the products shipped and services pursuant to this Agreement, which invoice may also reflect charges for freight, handling, taxes, installation and other amounts payable to PFP hereunder. All amounts specified in any such invoice shall be paid by Customer to PFP within thirty (30) days from the date of the invoice or as indicated on the original proposal or sales order. Any amounts due hereunder from Customer and not paid within thirty (30) days or agreed upon due date thereon shall bear interest at the lesser of the rate of one and one-half percent (1- ½ %) per month or the maximum rate permitted by applicable law. Such interest shall be in addition to and without limitation of any other rights or remedies which PFP may have under this Agreement or at law or in equity. PFP shall have the right and option to withhold service and parts. Customer agrees to pay any attorney's fees and costs incurred by PFP in the collection of any delinquent amounts due under this Agreement. Customer shall be responsible for all taxes arising out of or related to the provision of products and services ordered, including but not limited to sales, use and excise taxes, unless proper tax-exempt paperwork is provided during the proposal period. Such taxes shall be in addition to the sales price unless otherwise provided.

6. GOVERNING LAW: This Agreement shall be governed by and construed in accordance with the laws of the State of Washington and the exclusive forums for the resolution of any disputes hereunder shall be Washington state courts in the County of Snohomish, or federal courts in the State of Washington.

7. RETURNS: New, unused Finished Goods/Product currently sold by PFP may, but only with prior written authorization be returned. In no case is any equipment to be returned without a proper Return Authorization (RA). RA's must be assigned and approved. They can be obtained by contacting your Sales Representative or by calling our corporate office at 800-495-2008, hours of operation are 8:30AM-4:30PM Pacific Time.

PFP assumes no responsibility for damage caused by shipping or improper packaging, and all items being returned must be received by PFP in the same condition as when it was originally shipped/delivered to the Customer. Items being returned from the Customer's site will be handled by the original delivery company and will be prepaid by the Customer. Each returned item is subject to a 10% to 30% restocking charge of the purchase price of such product. Orders cancelled after shipment from the vendor to PFP or after production begins for built to order product are subject to a 20% restocking fee of the purchase price.

8. ACCEPTANCE BY CUSTOMER: The products shall be deemed accepted by Customer as of the date of receipt of the products by the Customer and signed acceptance of the Sales Order documents at the completion of the delivery and set up. IF within Ten (10) days after such date Customer gives PFP written notice that the products are not accepted and specifies in detail the reasons thereof. PFP may then, at its sole discretion, proceed to make necessary corrections, in which case such corrective action by PFP shall be Customer's sole remedy for non-acceptance of a product. Upon completion and acceptance of such corrections, the products will be deemed accepted by Customer. Under no circumstances shall Customer be entitled to revoke Customer's acceptance of the products.

9. WARRANTY: Each product shall have its own Limited Warranty. Such Warranty shall be the original Customer's sole and exclusive remedy for any breach of the Warranty. PFP makes no warranties, express or implied with respect to the equipment and expressly disclaims any implied warranty of merchantability and any implied warranty of fitness for purpose. Any warranty obligations are maintained between the original equipment manufacturer and the Customer and shall be governed by the requirements of the manufacturer's warranty requirements and specifications.

10. ASSUMPTION OF RISK/LIMITATION OF LIABILITY: The Customer and each user of the equipment are solely responsible for the proper use thereof. Improper use may result in personal injury. PFP will not be liable for any direct, special, indirect or consequential damages arising out of the improper use of the equipment. The purchase of this equipment signifies acceptance of all responsibility and liability of monitoring member's usage and liability of training at own risk. In no event will PFP be liable for any special, punitive, indirect, or consequential damages (including lost profits) resulting from the use or loss of use of the equipment, even if it has been advised of the possibility of such damage. This includes a) any improper or incomplete installation performed by the customer, b) installations that have been compromised after professional installation by PFP c) any misuse of the equipment by the end user. nor will PFP's liability to Customer (under contract, tort or otherwise) exceed the amount by Customer under this agreement for the relevant equipment or service.

11. FORCE MAJEURE: Delay in or failure to carry out the duties imposed upon either party (except Customer's duty to make invoiced payments to PFP) under this Agreement shall not constitute default hereunder or give rise to any claim for damages if such delay or failure results directly or indirectly from acts of God, acts of any civil or military authority, civil disturbances, war, strikes, or other labor disputes, shortages of labor or materials, fire, transportation contingencies, laws, regulations, acts or order or any government or agency or official thereof, other catastrophes or any other similar occurrences beyond such party's control, all of the aforesaid being herein for convenience referred to as "events of force majeure". In the event that PFP's work is delayed, impeded or rendered more costly to PFP by any event of force majeure, the price to the Customer hereunder shall be increased accordingly, upon at least thirty (30) days prior written notice to Customer, to reflect such increase in the cost to PFP, including without limitation, its increase in costs occasioned by the indirect effects of such event. Force majeure delays shall also extend the estimated delivery date on a day by day basis.

12. TERMINATION: Either party may terminate this Agreement at any time on fifteen (15) days written notice without cause. In the event of termination, Customer and PFP shall be relieved of all further obligations hereunder except Customer's obligation to pay PFP the total of PFP's outstanding invoices as of the date of termination and invoices on all orders and invoices in progress including without limitation, all costs, expenses and liabilities (including cancellation charges) incurred by PFP as a result of such termination.

13. WAIVER: No waiver of any provision of this Agreement or any rights or obligations of either party hereunder shall be effective or a continuing waiver, except pursuant to a written instrument signed by the party or parties waiving compliance. Any such waiver shall be effective only in the specific instance and the specific purpose stated in such written document.

14. SEVERABILITY OF PROVISIONS: No modification may be made to these Terms and Conditions unless the same is in writing, signed by an authorized corporate representative of PFP. These Terms and Conditions represent the entire understanding between PFP and Customer and there are no oral understandings. These Terms and Conditions supersede any prior discussions, understandings or agreements between Customer and PFP.

Without limiting the foregoing, it is expressly understood and agreed that each and every provision of this agreement which provides for a limitation of liability, disclaimer of warranties or exclusion of damages is intended by the parties to be severable and independent of any other such provision and to be enforced as such. Further, it is expressly understood and agreed that in the event any remedy hereunder is determined to have failed of its essential purpose, all limitations of liability and exclusion of damages set forth herein shall remain in full force and effect. In the event that any provision hereof is found invalid or unenforceable pursuant to judicial decree, the remainder of the Agreement shall remain valid and enforceable according to its terms.



Quotation

Mailing Address:
4686 Isabelle Unit A
Eugene, OR 97402

Date: 6/23/2020
Quote #: 30122566

Sales Representative:
Piper S.
541.343.3790 EXT 209
piper@commfitness.com

Bill To:
Leisure World Seal Beach
13533 Seal Beach Blvd.
Seal Beach, CA 90740

Ship To
Leisure World Seal Beach
13533 Seal Beach Blvd.
Seal Beach, CA 90740

Project

Terms: Net 30 (OAC)

Item	Description	Qty	Cost	Total
TARO302	TAG 30' 2" Black PolyDacron Battle Rope with Heat Shrink Grips (MSRP \$200)	1	100.00	100.00T
ESCO11	Escape Corebag 11lb Green (MSRP \$92)	1	83.00	83.00T
ESCO22	Escape Corebag 22lb Blue (MSRP \$97.50)	1	88.00	88.00T
ESCO33	Escape Corebag 33lb Red (MSRP \$104.50)	1	95.00	95.00T
ECREF	Echelon Reflect 50" with touchscreen display (MSRP \$1,999)	2	1,620.00	3,240.00T
ECSUB1	Echelon 1-Year Commercial Subscription: Includes std commercial warranty: 2 yrs parts; 2 yrs labor (MSRP \$699)	1	699.00	699.00T
F/I	Freight and Installation ** ESTIMATED - Actual based on completed Site Survey ** ** Does Not Include Removal of Existing Equipment. Quoted Upon Request ** Total sales tax calculated by AvaTax		28,995.00 27,453.65	28,995.00 27,453.65

NOTE: Consoles without Media Adapters accept coaxial connections only. Customer responsible for confirming with cable, satellite or IPTV provider that the Set-Top-Box or Video Distribution System is compatible with a coaxial input.

Total

\$341,209.65

Estimates reflect check/ACH payment.

Delivery and Installation Dates May Be Subject to Change Without Notice Based On Product Availability and Shipping Conditions. For Further Information, Please Consult CFE Standard Terms & Conditions.

Credit Card Payments are Accepted with an Additional 3.5% Convenience Fee

Quote valid for 30 days
Taxes As Applicable
CFE Standard Terms and Conditions Apply

Signature _____



Quotation

Mailing Address:
4686 Isabelle Unit A
Eugene, OR 97402

Date 6/23/2020
Quote # 30122566

Sales Representative:
Piper S.
541.343.3790 EXT 209
piper@commfitness.com

Bill To:

Leisure World Seal Beach
13533 Seal Beach Blvd.
Seal Beach, CA 90740

Ship To

Leisure World Seal Beach
13533 Seal Beach Blvd.
Seal Beach, CA 90740

Project

Terms: Net 30 (OAC)

Item	Description	Qty	Cost	Total
PRDP540	Precor Discovery 540 Chest Press (Plate-Loaded) (MSRP \$2,840)	1	2,475.00	2,475.00T
TAPLSETRU	TAG Rubber Plate 255lb Set (2ea-2.5,10,25,35,45 & 4ea-5's) (MSRP \$561.00)	5	350.60	1,753.00T
Misc.	Everlast Heavy Bag Stand	1	150.00	150.00T
Misc.	Everlast Leather Speed Bag	1	50.00	50.00T
Misc.	Escape Single HIIT Hub Wall TL, Wing, Holsters, Claw	1	4,995.00	4,995.00T
TAMB6	TAG Deluxe Medicine Ball- 6lb (MSRP \$46)	1	28.75	28.75T
TAMB8	TAG Deluxe Medicine Ball- 8lb (MSRP \$56)	1	35.00	35.00T
TAMB10	TAG Deluxe Medicine Ball- 10lb (MSRP \$60)	1	37.50	37.50T
TAMB12	TAG Deluxe Medicine Ball- 12lb (MSRP \$74)	1	46.25	46.25T
TAKB8	TAG Kettlebell- 8lb (MSRP \$20.80)	1	13.00	13.00T
TAKB12	TAG Kettlebell- 12lb (MSRP \$31.20)	1	19.50	19.50T
TAKB15	TAG Kettlebell- 15lb (MSRP \$39)	1	24.00	24.00T
TAKB25	TAG Kettlebell- 25lb (MSRP \$65)	1	40.00	40.00T
TAKB35	TAG Kettlebell- 35lb (MSRP \$91)	1	56.00	56.00T
TAKB45	TAG Kettlebell- 45lb (MSRP \$117)	1	73.00	73.00T
TASL10	TAG 10lb Slam Ball (Small) (MSRP \$36)	1	22.50	22.50T
TASL15	TAG 15lb Slam Ball (Small) (MSRP \$44)	1	27.50	27.50T
TASL20	TAG 20lb Slam Ball (Small) (MSRP \$54)	1	33.75	33.75T
TASL25	TAG 25lb Slam Ball (Large) (MSRP \$62)	1	38.75	38.75T
TAFR36	TAG Foam Roller, 36" (MSRP \$37.98)	2	23.75	47.50T
TRXCLUB4	TRX® Suspension Training® Solutions - CLUB4 (MSRP \$209.95)	2	200.00	400.00T

NOTE: Consoles without Media Adapters accept coaxial connections only. Customer responsible for confirming with cable, satellite or IPTV provider that the Set-Top-Box or Video Distribution System is compatible with a coaxial input.

Estimates reflect check/ACH payment.

Delivery and Installation Dates May Be Subject to Change Without Notice Based On Product Availability and Shipping Conditions. For Further Information, Please Consult CFE Standard Terms & Conditions.

Credit Card Payments are Accepted with an Additional 3.5% Convenience Fee

Quote valid for 30 days
Taxes As Applicable
CFE Standard Terms and Conditions Apply



Quotation

Mailing Address:
4686 Isabelle Unit A
Eugene, OR 97402

Date: 6/23/2020
Quote #: 30122566

Sales Representative:
Piper S.
541.343.3790 EXT 209
piper@commfitness.com

Bill To:

Leisure World Seal Beach
13533 Seal Beach Blvd.
Seal Beach, CA 90740

Ship To

Leisure World Seal Beach
13533 Seal Beach Blvd.
Seal Beach, CA 90740

Project

Terms: Net 30 (OAC)

Item	Description	Qty	Cost	Total
TADU60	TAG 60lb Premium Ultrathane Dumbbell (pair) (MSRP \$492.00)	1	307.00	307.00T
TADU65	TAG 65lb Premium Ultrathane Dumbbell (pair) (MSRP \$533.00)	1	333.00	333.00T
TADU70	TAG 70lb Premium Ultrathane Dumbbell (pair) (MSRP \$574.00)	1	358.00	358.00T
TADU75	TAG 75lb Premium Ultrathane Dumbbell (pair) (MSRP \$615.00)	1	384.00	384.00T
PRBE119	Precor Discovery 119 Multi-Adjustable Bench (MSRP \$1,200)	4	1,040.00	4,160.00T
PRBE113	Precor Discovery 113 Adjustable Decline Bench (MSRP \$1,090)	1	950.00	950.00T
PRBE116	Precor Discovery 116 Multi-Purpose Bench (MSRP \$560)	1	488.00	488.00T
PRBE312	Precor Discovery 312 Back Extension Bench (MSRP \$1,140)	1	993.00	993.00T
PRVKR	Precor Discovery 702 Vertical Knee Up (MSRP \$1,230)	1	1,072.00	1,072.00T
PRABX	Precor Icarian Ab-X100 Ab Bench (Gloss Metallic Silver Frame w/Black Upholstery) (MSRP \$1,350)	1	1,176.00	1,176.00T
PRDP601	Precor Discovery 601 Angled Leg Press (Plate-Loaded) (MSRP \$5,550)	1	4,835.00	4,835.00T
PRBE202	Precor Discovery 202 Preacher Curl Bench (MSRP \$1,030)	1	897.00	897.00T

NOTE: Consoles without Media Adapters accept coaxial connections only. Customer responsible for confirming with cable, satellite or IPTV provider that the Set-Top-Box or Video Distribution System is compatible with a coaxial input.

Estimates reflect check/ACH payment.

Delivery and Installation Dates May Be Subject to Change Without Notice Based On Product Availability and Shipping Conditions. For Further Information, Please Consult CFE Standard Terms & Conditions.

Credit Card Payments are Accepted with an Additional 3.5% Convenience Fee

Quote valid for 30 days
Taxes As Applicable
CFE Standard Terms and Conditions Apply



Quotation

Mailing Address:
4686 Isabelle Unit A
Eugene, OR 97402

Date: 6/23/2020
Quote #: 30122566

Sales Representative:
Piper S.
541.343.3790 EXT 209
piper@commfitness.com

Bill To:

Leisure World Seal Beach
13533 Seal Beach Blvd.
Seal Beach, CA 90740

Ship To

Leisure World Seal Beach
13533 Seal Beach Blvd.
Seal Beach, CA 90740

Project

Terms: Net 30 (OAC)

Item	Description	Qty	Cost	Total
PRDS605	Precor Discovery 605 Leg Extension (Selectorized Line) (MSRP \$4,950) August 2018 Edition	1	4,356.00	4,356.00T
PRDS619	Precor Discovery 619 Seated Leg Curl (Selectorized Line) (MSRP \$5,750) August 2018 Edition	1	5,520.00	5,520.00T
PRVIC008ES	Precor Vitality Inner / Outer Thigh (MSRP \$3,600)	1	2,851.00	2,851.00T
PRDS313	Precor Discovery 313 Back Extension (Selectorized Line) (MSRP \$4,250)	1	3,740.00	3,740.00T
PRDS714	Precor Discovery 714 Abdominal (Selectorized Line) (MSRP \$4,750)	1	4,222.00	4,222.00T
PRDS315	Precor Discovery 315 Rotary Torso (Selectorized Line) (MSRP \$4,850)	1	4,268.00	4,268.00T
PRIC302	Precor Icarian 302 Longpull w/Shroud, 250lbs (Selectorized) (MSRP \$3,875)	1	3,374.00	3,374.00T
PRIC304	Precor Icarian 304 Pulldown w/Shroud, 250lbs (Selectorized) (MSRP \$3,700)	1	3,224.00	3,224.00T
PRRA815	Precor Discovery 815 Dumbbell Rack- 3 Tier, 15 Pair (MSRP \$1,505)	1	1,310.00	1,310.00T
TADU5-50	TAG Premium Ultrathane Dumbbells- Complete set 5-50lbs SDS (MSRP \$2,255.00)	1	1,409.00	1,409.00T
TADU55	TAG 55lb Premium Ultrathane Dumbbell (pair) (MSRP \$451.00)	1	281.00	281.00T

NOTE: Consoles without Media Adapters accept coaxial connections only. Customer responsible for confirming with cable, satellite or IPTV provider that the Set-Top-Box or Video Distribution System is compatible with a coaxial input.

Estimates reflect check/ACH payment.

Delivery and Installation Dates May Be Subject to Change Without Notice Based On Product Availability and Shipping Conditions. For Further Information, Please Consult CFE Standard Terms & Conditions.

Credit Card Payments are Accepted with an Additional 3.5% Convenience Fee

Quote valid for 30 days
Taxes As Applicable
CFE Standard Terms and Conditions Apply



Quotation

Mailing Address:
4686 Isabelle Unit A
Eugene, OR 97402

Date: 6/23/2020
Quote #: 30122566

Sales Representative:
Piper S.
541.343.3790 EXT 209
piper@commfitness.com

Bill To:

Leisure World Seal Beach
13533 Seal Beach Blvd.
Seal Beach, CA 90740

Ship To

Leisure World Seal Beach
13533 Seal Beach Blvd.
Seal Beach, CA 90740

Project

Terms: Net 30 (OAC)

Item	Description	Qty	Cost	Total
Misc.	LF Circuit Series SC Leg Extension	1	2,995.00	2,995.00T
Misc.	LF Circuit Series SC Lat Pulldown	1	2,995.00	2,995.00T
Misc.	LF Circuit Series SC Seated Row	1	2,995.00	2,995.00T
Misc.	LF Circuit Series SC Squat	1	2,995.00	2,995.00T
Misc.	LF Circuit Series SC Shoulder Press	1	2,995.00	2,995.00T
Misc.	LF Circuit Series SC Triceps Press	1	2,995.00	2,995.00T
Misc.	LF Circuit Series Wheel Kit	1	150.00	150.00T
Misc.	LF Circuit Series Transition Exercise Kits (40 Placards)	1	150.00	150.00T
Misc.	LF Circuit Series Placard Stand	1	150.00	150.00T
PRFTSGL	Precor Icarian FTS Glide (MSRP \$4,045)	1	3,208.00	3,208.00T
PRDP802	Precor Discovery 802 Smith Machine (Plate-Loaded) (MSRP \$4,450)	1	3,876.00	3,876.00T
PRDS404	Precor Discovery 404 Chest Press (Selectorized Line) (MSRP \$4,250)	1	3,740.00	3,740.00T
PRDS304	Precor Discovery 304 Lat Pulldown (Selectorized Line) (MSRP \$4,550)	1	4,004.00	4,004.00T
PRDS505	Precor Discovery 505 Rear Delt/Pec Fly (Selectorized Line) (MSRP \$4,950)	1	4,356.00	4,356.00T
PRDS310	Precor Discovery 310 Seated Row (Selectorized Line) (MSRP \$4,250)	1	3,740.00	3,740.00T
PRDS602	Precor Discovery 602 Leg Press (Selectorized Line) (MSRP \$6,500)	1	5,720.00	5,720.00T

NOTE: Consoles without Media Adapters accept coaxial connections only. Customer responsible for confirming with cable, satellite or IPTV provider that the Set-Top-Box or Video Distribution System is compatible with a coaxial input.

Estimates reflect check/ACH payment.

Delivery and Installation Dates May Be Subject to Change Without Notice Based On Product Availability and Shipping Conditions. For Further Information, Please Consult CFE Standard Terms & Conditions.

Credit Card Payments are Accepted with an Additional 3.5% Convenience Fee

Quote valid for 30 days
Taxes As Applicable
CFE Standard Terms and
Conditions Apply



Quotation

Mailing Address:
4686 Isabelle Unit A
Eugene, OR 97402

Date: 6/23/2020
Quote #: 30122566

Sales Representative:
Piper S.
541.343.3790 EXT 209
piper@commfitness.com

Bill To:

Leisure World Seal Beach
13533 Seal Beach Blvd.
Seal Beach, CA 90740

Ship To

Leisure World Seal Beach
13533 Seal Beach Blvd.
Seal Beach, CA 90740

Project

Terms: Net 30 (OAC)

Item	Description	Qty	Cost	Total
PRAMT7331B	Precor 733 AMT w/ P31 Advanced LED Display Console- Black Pearl (MSRP \$7,595)	4	6,251.25	25,005.00T
STGA8LCD	Stairmaster 8 Series Gauntlet w/ LCD (MSRP \$7,599)	1	6,110.00	6,110.00T
PRTRM7311B	Precor 731 Treadmill w/ P31 Advanced LED Display Console- Black Pearl (MSRP \$7,545)	8	5,920.00	47,360.00T
CUSTOM	Scifit Recumbent Elliptical- Premium Seat, Foot Straps, Adapters	5	6,080.00	30,400.00T
PRRBK8351B	Precor 835 Recumbent Bike w/ P31 Advanced LED Display Console- Black Pearl (MSRP \$4,335)	7	3,208.00	22,456.00T
SCPROTBP	Scifit PRO Total Body- Adjustable Cranks-Premium Seat (MSRP \$5,695)	3	5,593.00	16,779.00T
PRUBK8351B	Precor 835 Upright Bike w/ P31 Advanced LED Display Console- Black Pearl (MSRP \$4,025)	1	2,940.00	2,940.00T
SCPROTBP	Scifit PRO Total Body- Adjustable Cranks-Premium Seat (MSRP \$5,695)	1	5,264.00	5,264.00T
CUSTOM	Lifecore Assault AirBike	1	799.00	799.00T
COMODROB	Concept 2- Model D Indoor Rower- Black	1	925.00	925.00T
ECBIEX1	Echelon Connect EX1 Upright Bike w/ Subscription	1	2,500.00	2,500.00T
	Life Fitness Subscription, Circuit			
Misc.	LF Circuit Series SC Ab Crunch	1	2,995.00	2,995.00T
Misc.	LF Circuit Series SC Biceps Curl	1	2,995.00	2,995.00T
Misc.	LF Circuit Series SC Chest Press	1	2,995.00	2,995.00T
Misc.	LF Circuit Series SC Seated Leg Curl	1	2,995.00	2,995.00T

NOTE: Consoles without Media Adapters accept coaxial connections only. Customer responsible for confirming with cable, satellite or IPTV provider that the Set-Top-Box or Video Distribution System is compatible with a coaxial input.

Estimates reflect check/ACH payment.

Delivery and Installation Dates May Be Subject to Change Without Notice Based On Product Availability and Shipping Conditions. For Further Information, Please Consult CFE Standard Terms & Conditions.

Credit Card Payments are Accepted with an Additional 3.5% Convenience Fee

Quote valid for 30 days
Taxes As Applicable
CFE Standard Terms and Conditions Apply

Exhibit B

#	Component	Quantity	Useful Life	Rem. Useful Life	Current Cost Estimate	
					Best Case	Worst Case
914	Wall Panel System - Replace	(2) Fixed Wall	30	27	\$19,000	\$25,000
945	Fitness Equipment - Replace	(46) Assorted Pieces	15	8	\$220,000	\$280,000
948	Ping Pong Tables - Replace	(10) Tables	10	5	\$8,400	\$10,000
951	Bathrooms - Remodel	(4) Bathrooms	20	11	\$84,000	\$100,000
1110	Interior Surfaces - Repaint	Approx 11,400 GSF	10	7	\$8,400	\$12,000
1115	Stucco - Repaint	Approx 8,200 GSF	10	7	\$20,000	\$24,000
1302	Flat Roof - Replace	Approx 10,000 GSF	20	5	\$64,000	\$74,000
1410	Bulletin Boards - Replace	(3) Boards	20	10	\$1,500	\$2,000
1800	Elevator - Modernize	(1) 2-Stop Hydraulic	25	5	\$82,000	\$120,000
1802	Elevator Cab - Remodel	(1) Elevator	20	9	\$7,400	\$9,600
Amphitheater						
317	Sewage Ejection Pump - Replace	(1) Pumps	15	1	\$7,300	\$8,400
317	Sewage Pumps - Replace	(2) 3-HP Pumps	15	8	\$7,200	\$8,200
317	Storm Pumps - Replace	(2) 1-HP Pumps	10	1	\$4,600	\$5,800
361	Large Pole Lights - Replace	(3) High Intensity	18	17	\$4,700	\$5,800
505	Brown 3' Iron Railing - Replace	Approx 206 LF	25	8	\$11,000	\$13,000
505	Brown Single Iron Railing - Replace	Approx 142 LF	25	8	\$3,200	\$4,200
505	White 3' Iron Railing - Replace	Approx 270 LF	25	8	\$12,000	\$14,000
505	White Single Pipe Railing - Replace	Approx 770 LF	25	8	\$20,000	\$22,000
601	Carpet - Replace	Approx 175 GSY	8	5	\$5,900	\$7,900
603	Vinyl Squares Floor - Replace	Approx 750 GSF	30	5	\$13,000	\$15,000
608	Hardwood Stage Floor - Replace	Approx 3,000 GSF	30	25	\$54,000	\$66,000
610	Hardwood Floor - Refurbish	Approx 3,000 GSF	10	5	\$13,000	\$15,000
814	Blast Doors - Replace	(1) Provision	25	5	\$72,000	\$130,000
910	News Room - Remodel	(1) Facility	12	6	\$10,000	\$14,000
916	Amateur Radio Equipment	(1) Allowance	10	5	\$7,300	\$8,400
916	Amateur Radio Room Furnishings	(1) Facility	15	5	\$2,300	\$3,400
918	Emergency Operations Center	(1) Facility	15	5	\$5,700	\$6,700
920	Theater Bleachers - Replace	Approx 4,350 LF Aluminum	30	18	\$450,000	\$490,000
920	Theater Club Furnishings - Replace	(1) Facility	15	5	\$5,200	\$6,400
920	Theater Drapery - Replace	(1) Allowance	10	8	\$34,000	\$44,000
920	Theater Lighting - Replace	(1) Allowance	30	5	\$66,000	\$87,000
920	Theater Rigging - Replace	(1) Allowance	30	25	\$23,000	\$34,000
920	Theater Sound - Replace	(1) Allowance	20	18	\$100,000	\$140,000
921	Ad/Production Room Facility	(1) Facility	15	10	\$43,000	\$55,000
922	Amphitheater Office Furnishings	(1) Multi-Office	15	4	\$10,000	\$12,000
925	Projector/DVD Player - Replace	(1) System	10	6	\$10,000	\$12,000
926	Main Server - Replace	(1) System	7	5	\$82,000	\$120,000
933	Pianos - Replace	(2) Pianos	30	10	\$23,000	\$33,000
951	Bathrooms - Major Refurbish	(10) Bathrooms	30	2	\$100,000	\$120,000
970	Camera System - Replace	(1) Allowance	12	10	\$13,000	\$19,000
1101	Doors - Repaint	(90) Sides	5	3	\$2,300	\$3,100
1110	Interior Surfaces - Repaint	Approx 16,000 GSF	10	4	\$14,000	\$16,000
1113	Metal Surfaces - Repaint	Approx 2,000 GSF	5	4	\$3,700	\$4,700
1115	Exterior Flatwork - Repaint	Approx 16,000 GSF	10	4	\$18,000	\$20,000
1116	Wood Surfaces - Repaint	Approx 5,000 GSF	5	4	\$8,500	\$9,600
1302	Cap Sheet Roof - Re-coat	Approx 9,000 GSF	10	9	\$12,000	\$19,000
1302	Cap Sheet Roof - Replace	Approx 13,,000 GSF	20	19	\$105,000	\$145,000

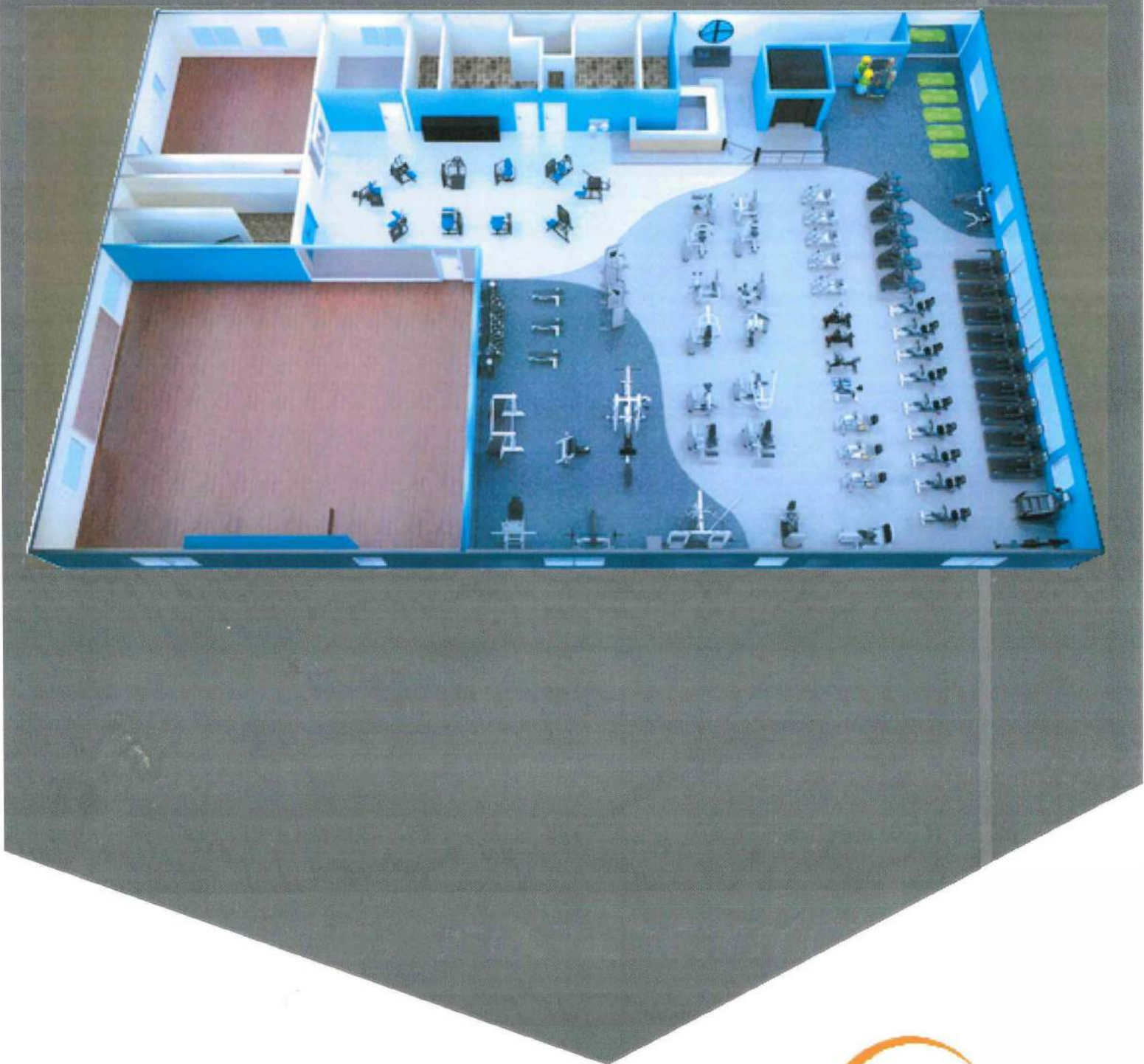

ew Equipment Recommendation Report
 isure World

ALLAN CONSULTING
 00 S. Hope Street Suite #103
 s Angeles, Ca 90015



6/8/20



THE FACTS

Physical Activity and Health: A Report of the Surgeon General

Facts

- The loss of strength and stamina attributed to aging is in part caused by reduced physical activity.
- Inactivity increases with age. By age 75, about one in three men and one in two women engage in no physical activity.
- Social support from family and friends has been consistently and positively related to regular physical activity.



Benefits of Physical Activity

- Helps maintain the ability to live independently and reduces the risk of falling and fracturing bones.
- Reduces the risk of dying from coronary heart disease and of developing high blood pressure, colon cancer, and diabetes.
- Can help reduce blood pressure in some people with hypertension.
- Helps people with chronic, disabling conditions improve their stamina and muscle strength.
- Reduces symptoms of anxiety and depression and fosters improvements in mood and feelings of well-being.
- Helps maintain healthy bones, muscles, and joints.
- Helps control joint swelling and pain associated with arthritis.

Key Messages

- Older adults can benefit from regular physical activity.
- Physical activity need not be strenuous to achieve health benefits.
- Older adults can obtain significant health benefits with a moderate amount of physical activity, preferably daily. A moderate amount of activity can be obtained in longer sessions of moderately intense activities (such as walking) or in shorter sessions of more vigorous activities (such as fast walking or stairwalking).
- Additional health benefits can be gained through greater amounts of physical activity, either by increasing the duration, intensity, or frequency. Because risk of injury increases at high levels of physical activity, care should be taken not to engage in excessive amounts of activity.
- Previously sedentary older adults who begin physical activity programs should start with short intervals of moderate physical activity (5-10 minutes) and gradually build up to the desired amount.
- In addition to cardiorespiratory endurance (aerobic) activity, older adults can benefit from muscle-strengthening activities. Stronger muscles help reduce the risk of falling and improve the ability to perform the routine tasks of daily life.

What Communities Can Do

- Provide community-based physical activity programs that offer aerobic, strengthening, and flexibility components specifically designed for older adults.
- Ensure that facilities for physical activity accommodate and encourage participation by older adults.
- Provide transportation for older adults to parks or facilities that provide physical activity programs.
- Encourage health care providers to talk routinely to their older adult patients about incorporating physical activity into their lives.
- Plan community activities that include opportunities for older adults to be physically active.



THE SOLUTION

Leisure World Seal Beach has already taken a major step towards promoting health and wellness within their community. Although the current gym offers a great mix of equipment to accommodate the needs of all the residents there are some additional components that can be addressed to ensure that the majority of the community have access to everything they need within the fitness facility to stay healthy and active.

After touring the facility we have determined a few key area of improvements that can be made to create a health club and environment that will attract the most members within the Leisure World community. As a result, a number of additional benefits can be achieved as a “return of investment” into the current gym refresh including but not limited to longer life expectancies, healthier living, and increased property values.

Leisure World Current Gym Equipment Issues:

Age of Equipment



PROBLEM: The majority of equipment is at least six years old. Once equipment reaches the end of its “lifespan” equipment costs soon outweigh the purchase of new equipment under warranty. In addition, liability risks go up with older equipment.

SOLUTION: Trade out old equipment with new state-of-the-art equipment with full warranties

Additional Equipment Needs



PROBLEM: Although the aging population uses a majority of the same equipment as your typical gym-goer there are some speciality pieces that are specific to the retirement communities.

SOLUTION: Purchase new equipment to supplement the equipment already offered to increase usage within the community.

Equipment Flow/Size of Space

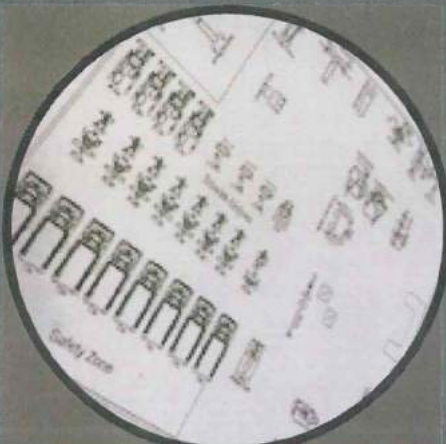

PROBLEM: The current gym does not have the best flow. Walkways are not clearly defined in terms of ADA compliance and there are no specific areas for the different types of equipment and exercises.

SOLUTION: Redefine spaces within the gym and create a better flow using the new equipment that is more visually appealing.

Why Purchase New Equipment.

Fitness centers, in general, follow a fairly standard blueprint when it comes to updating/replacing equipment. Big gyms struggle to attract and maintain clientele so they must always offer the newest and best equipment in a wide selection. In a facility such as the Leisure World gym there are other variables to consider when faced with the decision of when to replace outdated equipment. Some are straight forward such as:

- New equipment provides a clean look and creates a new, fresh, motivating atmosphere
- New equipment often incorporates the latest in biomechanics, safety, and technology
- New equipment can reduce risk of injury often seen in older equipment
- New equipment can follow current trends or offer a new type of workout to the facilities members.

When we consult on a project we break the fitness center down into three equipment categories – (cardiovascular equipment, strength equipment, and freeweight equipment) and create basic recommendations within these categories.

Leisure World Fitness Center Recommendations:

Cardiovascular Equipment: Replace all cardiovascular equipment. All equipment is well past the warranty period and shows signs of wear. It is not uncommon for repairs to run up to \$1000 (belt/deck/electronics). Equipment looks dated as well. We also recommend adding a few additional pieces after determining member usage and getting feedback from the front desk staff on high-use pieces.

Strength Equipment: Strength equipment is well past warranty and showing signs of wear. Liability risks go up with outdated strength equipment due to potential of failure. Also, there are currently a number of different lines of strength. Changing out will decrease liability risk and provide a much more uniform appealing look. In addition to changing out pieces we are recommending adding a line made specifically for the elderly population which is much less intimidating and more user-friendly. This line can be used individually or in a circuit class setting.

Freeweight Equipment: Current freeweight are a mix of many different types but all showing signs of excessive wear. Dumbbells are rusted and flaking and the benches are chipped. We recommend replacing with new racks and urethane dumbbells which are quiet and do not chip the equipment. Benches and freeweight equipment will be updated and will all have a uniform look. In addition, we are recommending adding more functional pieces for a dedicated area.

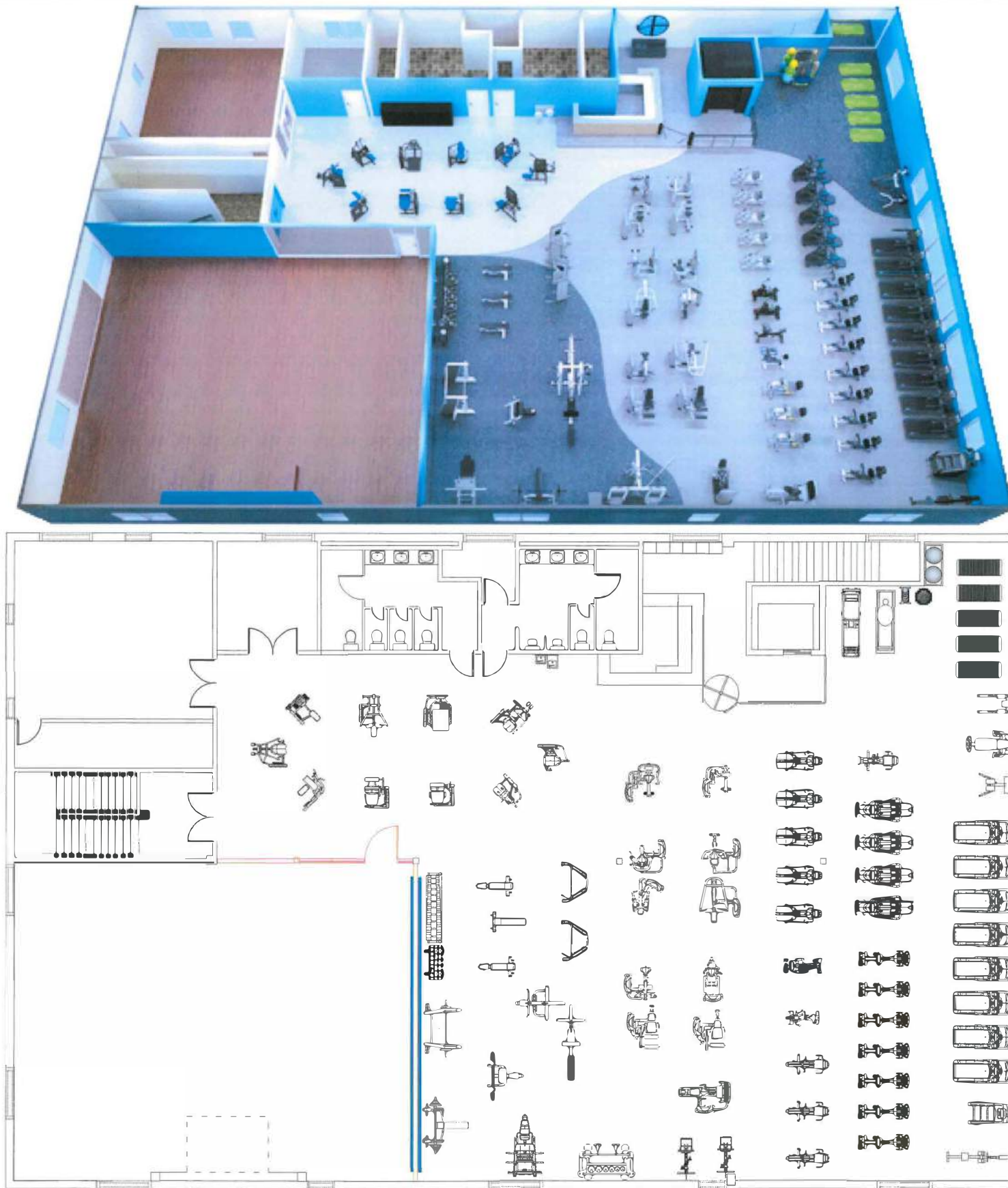



New Circuit and Freeweight Are

- Replace all old equipment
- Offer same featured equipment
- Reorganize for better flow
- Space for 6'



New Cardio Area

- Replace all old equipment
- Offer same featured equipment
- Add additional high-use pieces
- Space more efficiently



New Easy Circuit Area

- Brand new line
- Easy to use equipment
- Non-intimidating
- Set-up for class structure

Cardiovascular Equipment				
Name	Old Make & Model	Replacement Make/Model	Old Quantity	New Quantity
Recumbent Bike	Matrix Re-3X	Precor RBK 835 P30	7	7
Treadmill	Matrix T-3X	Precor 731-P30	8	8
Hybrid Bike	Matrix - Re3X	Sci--Fit Pro 2	3	3
Upright Bike	Matrix Re-3X	Precor UBK 835 P30	1	1
Airydyne Bike	Schwinn	Assault Bike	1	1
Ascent Trainer	Matrix A/E-3X	Precor AMT 733 - P30	4	4
Climber	Matrix	Gauntlet	1	1
Seated Elliptical	Nu-Step	Sci-Fit REX	3	5
Rower	Concept 2	Concept 2	1	1
UBE	Martix	Sci-Fit Pro 1000	1	1

Strength Equipment				
Name	Make	Replacement	Old Quantity	New Quantity
Multi-Gym	Magnum	Precor Longpull/Pulldown	1	1
Functional Trainer	LifeFitness	Precor FTS Glide	1	2
Seated Row	Matrix	Precor Seated Row	1	1
Seated Leg Curl	Matrix	Precor Leg Curl	1	1
Leg Press	Matrix	Precor Leg Press	1	1
Leg Extension	Matrix	Precor Leg Extension	1	1
Pec	Matrix	Precor Rear Delt/Pec	1	1
Rotary Torso	Matrix	Precor Rotary Torso	1	1
Abdominal	Matrix	Precor Abdominal	1	1
Back Extension	Matrix	Precor Back Extension	1	1
Inner/Outer Thigh	Matrix	Precor Inner/Outer	1	1
Chest Press	Martix	Precor Chest Press	1	1
Lat Pulldown	Matrix	Precor Lat Pulldown	1	1
Circuit - A Crunch		Lifefitness	0	1
Circuit - Bicep Curl		Lifefitness	0	1
Circuit - Chest Press		Lifefitness	0	1
Circuit - Leg Curl		Lifefitness	0	1
Circuit - Leg Extension		Lifefitness	0	1
Circuit - Lat Pulldown		Lifefitness	0	1
Circuit - Seated Row		Lifefitness	0	1
Circuit - Squat		Lifefitness	0	1
Circuit - Shoulder Press		Lifefitness	0	1
Circuit - Tricep		Lifefitness	0	1

Misc Equipment				
Category	Make	Replacement	Old Quantity	New Quantity
Total Gym	TG	none	1	0
Reformer		none	1	0
Misc Balls		Assorted	1	1
Misc Stretch Mats		Assorted	1	1
Misc Rollers		Assorted	1	1
Heavy Bag/Speed Bag		Escape HUB	1	1

Freeweight Equipment				
Category	Make	Replacement	Old Quantity	New Quantity
Preacher Curl		Precor Preacher Curl	1	1
Angled Leg Press/Hack		Precor Angled Leg Press	1	1
Ab Bench/Ladder		Precor Ab Bench	1	1
Olympic Bench		Precor Olympic Bench	1	1
PL Dip/Chest Combo	Nautilus	none	1	0
DB Rack	Assorted	Precor	1	1
Dumbbells	Assorted	Urethane Dumbbells	1	1
Bars	Assorted	Assorted	1	1
Benches	Assorted	Assorted	1	1
		Precor VKR	0	1
		Precor Back Extension	0	1

On Demand Equipment				
Category	Make	Replacement	Old Quantity	New Quantity
On Demand Spin Class		Eschelon Bike	0	2
On Demand TV Class		Eschelon Mirror Reflect	0	2

Current Pieces



Treadmill



TRM 731 Experience™ Series

The insight driven design of the TRM 731 delivers the same reliability, performance, and efficiency that Precor is known for at a budget-friendly price. Built for high-use on our commercial platform, the treadmill sacrifices nothing in longevity, making it a money-saving valuable investment. Features like the Active Status Light make it easy to maintain for any of your staff and decreases product downtime. At the same time, the TRM 731 delivers a consistent Precor feel and comfort for your exercisers. The P31 LED console provides exercisers with essential workout metrics for an effective fitness experience.



Ascent Trainer



AMT® 733 Experience™ Series

The innovative and durable design of the AMT® 733 has an adaptive stride length and fixed stride height to provide exercisers of all fitness levels with a wider range of motions during workouts. The AMT 733 intuitively responds to users' natural motion, allowing them to adapt their stride length for a comprehensive cardio workout - all without so much as the push of a button. To round out the workout experience, the P31 LED console provides exercisers with the essential fitness stats.



Recumbent Bike



UBK 835 Experience™ Series

The self-powered UBK 835 upright bike features custom-designed handlebars with integrated touch heart rate for maximum comfort and efficient workout experience. One-handed seat adjustment on or off the bike, redesigned saddle for riding comfort and improved knee over pedal spindle (KOPS) geometry for efficient pedalling mean a smooth, comfortable workout.



Upright Bike



RBK 835 Experience™ Series

The RBK 835 recumbent bike features our P31 console and a step-through design to appeal to a wide range of exercisers of all ages. The simple seat adjustment allows the user to change the position of the seat with one hand, either on or off the bike. A ventilated air flex seat provides exceptional comfort.

Current Pieces



UBE



Nu-Step



Hybrid Bike



PRO1000 with Premium Seat

PRO1000

Seated Upper Body

The PRO1000's adjustable arm cranks, accessibility and low starting resistance make it easy to get on and go.

- Adjustable arm cranks: 3 ROM settings plus unison motion
- Step-through accessibility
- Bi-directional exercise
- Iso-Strength safe, accommodating strength program
- Very low starting resistance with 191 levels of resistance
- Premium, standard and bariatric seat options
- Removable seat for wheelchair access



REX™

Total Body Recumbent Elliptical

REX's smooth, natural knee movement replicates climbing stairs to improve functional gait.

- Smooth, elliptical movement for efficient total body exercise in both directions
- Knee-to-elbow core exercise
- Comfortable, sturdy orthopedic footbeds with safety edge
- Seat swivels for easy access
- Very low starting resistance
- Bi-directional exercise
- Dual position handles allow muscle change on the fly
- Foot straps included on REX7001

PRO2 Total Body



PRO2®

Total Body

The industry's most versatile rehabilitation tool, the PRO2® is an upper body exerciser and lower body recumbent bike in one for a total body solution. Dependent upper and lower cranks enable passive assistance.

- Upper, lower or total body exercise for versatile rehab
- Dependent motion allows stronger extremities to assist weaker ones
- Adjustable upper and lower cranks: 3 length settings
- Easy access with track, adjustable step through
- Removable seat for wheelchair accessibility
- Premium, standard and bariatric seat options
- 360 Therapist Assist Pedal on seat
- Bi-directional exercise
- Iso-Strength safe, accommodating strength program
- Very low starting resistance

Current Pieces



Rower



Concept 2 Model D Rowing Ergometer:

Features an advanced PM5 Performance Monitor, improved ergonomically designed handles, adjustable foot-rests, and a flywheel designed for smooth movement with minimal noise. The Model D has a comfortable 14" (seat) height with an aluminum I-beam monorail and stainless steel track for a consistent back-and-forth slide. When done training, you can quickly break down the rower into two segments for storage or use the included caster wheels for easy transport. Rogue offers an optional space saving wall hanger.

The Concept 2 Rower provides one of the more comprehensive, full-body workouts of any fitness machine. Engineered to last a lifetime, it's low impact enough for use in physical rehabilitation centers, and intensive enough to be used by the world's fittest athletes.



Airdyne



Assault AirBike Elite

The Assault AirBike Elite takes interval training to the next level, with a smooth ride, ergonomic design, and enhanced console capabilities that deliver an intense and refined workout experience. Individualized and infinite adjustments allow exercisers to keep it mellow and level to target a heart rate, or jump to high intensity interval training for a serious workout.



Stepper



StairMaster 8 Series Gauntlet StepMill

The 8 Series Gauntlet StepMill by Stairmaster is a commercial-rated step machine with revolving stairs to provide a cardio workout experience to the exerciser of true stairclimbing. For nearly 30 years, the StairMaster StepMill has been called the toughest workout in the gym. Now you can bring that same toughness to your home workouts with the totally redesigned GAUNTLET. The Gauntlet StepMill is easy to recognize - it's the piece of cardio equipment that looks brutal compared to all the others, with a revolving set of 8-inch stairs that closely duplicates the workout of actual stair climbing. Each time you mount the Gauntlet StepMill, the unit's electronically controlled, chain-driven alternator precisely controls the pedal descent, allowing a wide range of users to exercise smoothly within their comfort zones. The resulting step range of 26 to 162 steps per minute will strengthen your legs, boost your cardio, and challenge even the fittest of users.

Current Pieces



Seated Row



Leg Curl



Leg Press



Leg Extension



Rear Delt/Pec



Current Pieces



Rotary Torsion



Abdominal



Low Back



Inner/Outer Thigh



Lat Pulldown



Current Pieces

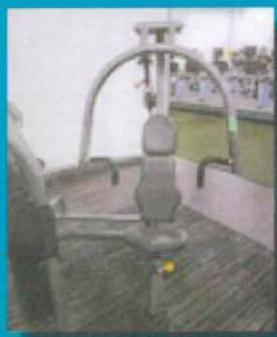

Chest Press



Silver/Blue Option

Low Row



Lat Pulldown



Glide FTS



White/Grey Option

Frame: Gloss Metallic Silver



Upholstery: Navy



STRENGTH EQUIPMENT OPTIONS

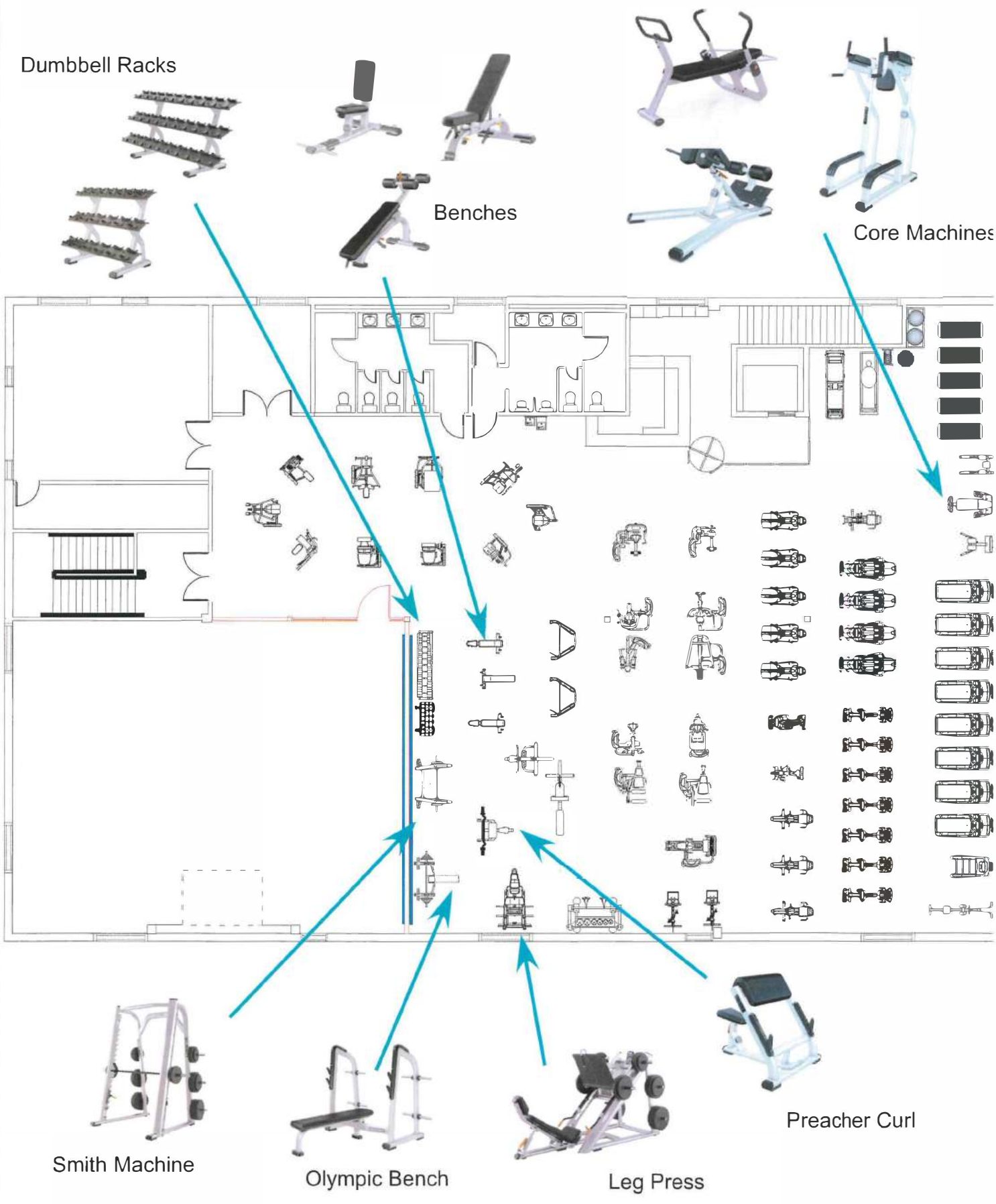



ECHELON Bike - On Demand Classes



ECHELON REFLECT 50" TOUCHSCREEN - On Demand Classes



Current Pieces



escape[®]

**ONE BAY.**

Great for small to medium clubs, small boutiques or larger hotel gyms looking for an engaging workout station to run around as the central point of group circuit programmes. The eye-catching design will ensure it is the focus of any group X, PT or individual functional training regime.

Cardiovascular Equipment				
Name	Old Make & Model	Replacement Make/Model	Old Quantity	New Quantity
Recumbent Bike	Matrix Re-3X	Precor RBK 835 P30	7	7
Treadmill	Matrix T-3X	Precor 731-P30	8	8
Hybrid Bike	Matrix - Re3X	Sci--Fit Pro 2	3	3
Upright Bike	Matrix Re-3X	Precor UBK 835 P30	1	1
Airydyne Bike	Schwinn	Assault Bike	1	1
Ascent Trainer	Matrix A/E-3X	Precor AMT 733 - P30	4	4
Climber	Matrix	Gauntlet	1	1
Seated Elliptical	Nu-Step	Sci-Fit REX	3	5
Rower	Concept 2	Concept 2	1	1
UBE	Martix	Sci-Fit Pro 1000	1	1

Strength Equipment				
Name	Make	Replacement	Old Quantity	New Quantity
Multi-Gym	Magnum	Precor Longpull/Pulldown	1	1
Functional Trainer	LifeFitness	Precor FTS Glide	1	2
Seated Row	Matrix	Precor Seated Row	1	1
Seated Leg Curl	Matrix	Precor Leg Curl	1	1
Leg Press	Matrix	Precor Leg Press	1	1
Leg Extension	Matrix	Precor Leg Extension	1	1
Pec	Matrix	Precor Rear Delt/Pec	1	1
Rotary Torso	Matrix	Precor Rotary Torso	1	1
Abdominal	Matrix	Precor Abdominal	1	1
Back Extension	Matrix	Precor Back Extension	1	1
Inner/Outer Thigh	Matrix	Precor Inner/Outer	1	1
Chest Press	Martix	Precor Chest Press	1	1
Lat Pulldown	Matrix	Precor Lat Pulldown	1	1
Circuit - A Crunch		Lifefitness	0	1
Circuit - Bicep Curl		Lifefitness	0	1
Circuit - Chest Press		Lifefitness	0	1
Circuit - Leg Curl		Lifefitness	0	1
Circuit - Leg Extension		Lifefitness	0	1
Circuit - Lat Pulldown		Lifefitness	0	1
Circuit - Seated Row		Lifefitness	0	1
Circuit - Squat		Lifefitness	0	1
Circuit - Shoulder Press		Lifefitness	0	1
Circuit - Tricep		Lifefitness	0	1

Exhibit C

OLD VS. NEW EQUIPMENT SPREADSHEET

Misc Equipment				
Category	Make	Replacement	Old Quantity	New Quantity
Total Gym	TG	none	1	0
Reformer		none	1	0
Misc Balls		Assorted	1	1
Misc Stretch Mats		Assorted	1	1
Misc Rollers		Assorted	1	1
Heavy Bag/Speed Bag		Escape HUB	1	1

Freeweight Equipment				
Category	Make	Replacement	Old Quantity	New Quantity
Preacher Curl		Precor Preacher Curl	1	1
Angled Leg Press/Hack		Precor Angled Leg Press	1	1
Ab Bench/Ladder		Precor Ab Bench	1	1
Olympic Bench		Precor Olympic Bench	1	1
PL Dip/Chest Combo	Nautilus	none	1	0
DB Rack	Assorted	Precor	1	1
Dumbbells	Assorted	Urethane Dumbbells	1	1
Bars	Assorted	Assorted	1	1
Benches	Assorted	Assorted	1	1
		Precor VKR	0	1
		Precor Back Extension	0	1

On Demand Equipment				
Category	Make	Replacement	Old Quantity	New Quantity
On Demand Spin Class		Eschelon Bike	0	2
On Demand TV Class		Eschelon Mirror Reflect	0	2

6/8/20

THIS
PAGE
LEFT
BLANK
INTENTIONALLY



Golden Rain Foundation

Golden Rain Foundation

Leisure World, Seal Beach

BOARD ACTION REQUEST

TO: GRF BOARD OF DIRECTORS
FROM: RANDY ANKENY, EXECUTIVE DIRECTOR
SUBJECT: APPROVE SALE/DISPOSAL OF EXISTING FITNESS EQUIPMENT
DATE: JUNE 24, 2020
CC: FILE

Contingent upon Board action to purchase new fitness equipment, existing equipment must be disposed of per Governing document 40-3323-3, Disposition of Surplus Equipment, (attached). The first sentence of the document states:

“...All surplus property and equipment which has come to an end of its useful life to the community is to be disposed of in such manner as to yield a maximum financial return...”

In reviewing various options under the terms of the document, to secure the “maximum financial return” and based upon the varied types of equipment, all equipment would have to be sold “as is” with a clear release of all warranty and liability at time of sale:

The Golden Rain Foundation, Seal Beach (“Seller”), for good and valuable consideration, the receipt and sufficiency of which are hereby acknowledged, does hereby bargain, sell, quitclaim, transfer, deliver, and convey, all without representation or warranty, to name (“Buyer”), all of Seller’s right, title, and interest in and to the following used personal property (the “Property”) located as of the date hereof “AS-IS”, “WHERE IS” and “WITH ALL FAULTS”:

List property being conveyed:

Buyer and Seller acknowledge as follows:

THE PROPERTY TRANSFERRED HEREIN IS IN USED CONDITION AND IS TRANSFERRED “AS IS” AND “WHERE IS”. SELLER MAKES NO EXPRESS OR IMPLIED WARRANTIES OR REPRESENTATIONS OF ANY KIND WHATSOEVER IN REGARD TO THE EQUIPMENT. SELLER HEREBY DISCLAIMS ANY AND ALL REPRESENTATIONS AND WARRANTIES IN REGARD TO THE PROPERTY, INCLUDING, WITHOUT LIMITATION, THOSE OF MERCHANTABILITY, FITNESS FOR USE OR FITNESS FOR ANY

PARTICULAR USE, OR OF QUALITY, DESIGN, CONDITION, CAPACITY, SUITABILITY OF PERFORMANCE.

Buyer represents and warrants that it has fully examined and inspected the Property, and has not relied and is not relying upon Seller to assist it in any way in such examination or inspection, or in the operation, maintenance, service or repair of the Property, nor shall Seller provide any assistance with delivery and set up of the Property.

As strong limitations are imposed to mitigate possible risk and liability, an option is available to consign the equipment to K Allan Consulting, who has the industry knowledge and contacts to potentially sell the equipment for a possible maximum financial return.

I move to approve a variance to Governing Document 40-3323-3, Disposition of Surplus Equipment, to dispose of surplus GRF property as Identified as the existing Fitness Equipment to K Allen Consulting, to seek the maximum financial return on the disposition of the property. K Allen Consulting shall provide a detailed inventory of all property consigned and shall provide to GRF a return of 30 % of the sale to GRF as a condition of the consignment of the property for sale.

**Disposition of Surplus Equipment**

All surplus property and equipment which has come to the end of its useful life to the community is to be disposed of in such a manner as to yield a maximum financial return to the Golden Rain Foundation (GRF). Foundation/Mutual surplus equipment may not be sold, traded-in, salvaged, scrapped, donated or otherwise disposed of without prior approval from the Finance Committee and will be executed at the lowest possible cost. In keeping with this policy, the following steps will be considered due diligence for disposal of surplus property:

1. INITIATION OF DISPOSAL PROCESS:

When a Mutual or GRF department seeks to declare property as surplus, the Purchasing Manager will be advised of intent to transfer surplus property to the warehouse for the removal process via Equipment Transfer/Disposition of Equipment form sent via email. In turn, the Purchasing Manager will then initiate and execute the steps outlined below for removal.

2. DISPOSAL BY INTERNAL TRANSFER:

For GRF properties priority will be given to internal re-circulation of properties in an attempt to repurpose surplus items. The Purchasing Manager will communicate via email to department heads notification of property available on a first come, first serve basis. If there is no call for repurposing, the Purchasing Manager will present a list of the items received as surplus, along with an assessment of fair market value, to the Finance Committee for review and approval.

3. DISPOSAL BY SALE TO SHAREHOLDERS:

GRF and Mutual property deemed to have a resale value, will be sold on a first come, first serve basis at the approved set price or open for best offer. Items will be sold "as is" for pickup. Notification of items for sale will be done through the classified section of the LW Weekly for the period of at least one week. Mutual items that cannot be sold internally will be reported back to the mutual contact for further disposition. If no further disposition is received from the Mutual contact after seven (7) days items will continue through the following steps with any remaining GRF items.

4. DISPOSAL BY DONATION:

GRF Items that cannot be sold internally may be donated to nonprofit organizations.

5. DISPOSAL AS WASTE:

GRF Items that cannot be sold or donated will be discarded through the GRF's normal scrap, recycle or waste removal process.

PURCHASING

40-3323-3

Disposition of Surplus Equipment



6. FINAL REPORTING:

Final disposition of all disposed items will be reported back to the Finance Committee by the Purchasing Manager. Mutuals will be credited for items sold on their behalf, where appropriate.

Document History

Adopted: 16 Dec 69	Amended: 15 Sep 86	Amended: 22 Jul 14
Amended: 25 Apr 17	Amended: 23 Jul 19	

Keywords: Surplus Disposal Equipment Purchasing Donation



Golden Rain Foundation

Golden Rain Foundation

Leisure World, Seal Beach

BOARD ACTION REQUEST

TO: GRF BOARD OF DIRECTORS
FROM: DEANNA BENNETT, EXECUTIVE COORDINATOR, ON BEHALF OF VARIOUS GRF BOARD DIRECTORS
SUBJECT: APPROVE OPENING OF MISSION PARK, STAGE 1- PICKLEBALL, UNDER REQUIRED COVID-19 GUIDELINES
DATE: JUNE 25, 2020
CC: FILE

Guidelines were recommended for the reopening of the following outdoor facilities, under the required Covid-19 guidelines, at the Mission Park area, at the June 23, 2020 GRF Board of Directors meeting, which included Pickleball/ Multipurpose Courts, scheduled to reopen in two stages: Stage 1 - Pickleball and Stage 2 – Bocce ball.

The Board moved to remove the item from the agenda. Below are recommended revisions to the guidelines by Board members Findlay, Hopewell, Perrotti, Rapp, and Thompson.

8 MISSION PARK (include days and hours of operation? Limit daily operations to 8
9 hours?)

10 Stage 1 - Pickleball

11 The following protocol has been expanded pursuant to regulations recommended
12 by the USA Pickleball Association USAPA and incorporates guidelines for at-risk
13 senior communities in particular.

14 1. Play at the Pickleball cCourt, when opened, must be booked through the
15 Recreation Department by email only. No unscheduled games will be allowed.

16 • a. Requests are accepted at <http://www.lwsb.com/reserve/> **Monday through**
17 **Friday before 4:00 PM** for play the following day. Reservations for Saturday,
18 Sunday and Monday must be made on Friday before 4:00 p.m.

19 • b. Players must check in with the Clubhouse custodian to verify their
20 reservation.

21 • c. Staff may request your GRF ID at any time. [Reformatted for clarity. No
22 content change.]

2. No unscheduled games will be allowed.
- 2.3. No gathering will be permitted before or after games. [Moved up from end of game specifics]
- 3.4. ~~In order to~~ To eliminate touch points, benches, score tenders, and all tables and chairs will be removed. [Moved up from after game rules.]
- 4.5. Face coverings must be worn in all areas until playing begins on the court. Face coverings also must be worn after completing play is completed. [Moved from after game to general rules]
- 5.6. Social distancing is as defined by the CDC of (maintaining 6 feet of distance) must be maintained at all times. [Separated from face coverings and moved up, too.]
- 6.7. Wash your hands with soap and water (for 20 seconds or longer) or use a hand sanitizer. ~~if soap and water are not readily available before going to the court. Players should w~~ Wash or use hand sanitizer between games and immediately after match is completed. ~~Players should consider using hand sanitizer between games.~~
- 7.8. A disinfecting/sanitizing bucket will be on site, between bBocce and pPickleball courts for players to use to clean pickleball balls and and paddles. [Moved from end to general and combined with variations.]
- 8.9. The Clubhouse Two restrooms will be made available; however, no more than 2 players per restroom will be permitted at a time.
- 9.10. ~~Pickleball games are limited to one hour of play (2 players per court), singles matches only. Playing doubles, which could lead to incidental contact and unwanted proximity, is prohibited: singles matches (2 players per court) only. USAPA guidelines recommends avoiding doubles play as doubles are not conducive to for 6-foot social distancing and lead to incidental contact with playing partners. GRF We continues to monitor changes to USAPA guidelines and hope to add doubles play when it is deemed safe. Move yellow highlighted content to footnotes.]~~
- 10.11. ~~Pickleball players must provide their own paddles, balls and gloves, and gloves must be worn Wwear gloves~~ when handling the ball. Do not touch other players' equipment.
- 11.12. ~~Select one set of colored balls; have your playing partner select a set of different colored balls. If different colors are not an option, use a Sharpie and prominently mark personal pickleballs with each player's your initials.~~
- ~~a. Players must wash and sanitize pickleball balls and racquet paddles after each match in the provided disinfecting bucket. A disinfecting bucket will be on-site for ayers to use to clean pickleball balls and paddle..~~
- 12.13. ~~Proceed with play, making certain to pick up only the your identified colored balls only. [Separated from ball selection rules above]~~
- ~~a. Should a ball with the other color identified with another player wind up on your side of the court, do not touch the ball with your hands. Use your paddle or feet to advance the ball to the other side of the court. Do not touch errant balls from another courts, rather return the balls with your feet kick it them back or use your paddle.~~
- 13.14. ~~Face coverings must be worn in all areas until playing begins on the court. Face coverings also must be worn after completing play. Moved from after game to general rules]~~
- 14.15. ~~Social distancing is as defined by the CDC of (maintaining 6 feet of distance) must be maintained at all times. [Separated from face coverings and moved up, too.]~~

- 73 15. ~~16.~~ Wash your hands with sap and water (for 20 seconds or longer) or use a
74 hand sanitizer if soap and water are not readily available before going to the court.
75 Players should w Wash or use hand sanitizer ~~between games and~~ immediately
76 after match is completed. Players should consider using hand sanitizer between
77 games. [Also moved up.]
- 78 16. ~~17.~~ In order to eliminate touch points, benches, score tenders, and all tables
79 and chairs will be removed. [Moved to top after gathering.]
- 80 17. ~~After the match players must~~ T thoroughly wash paddles, grips, pickleballs,
81 towels, clothes, bags, water bottles and other items you ~~they~~ have used or
82 touched. [This follows #12. Items numbered 13 to 16 have been moved.]
- 83 18. **No after-game congregation/socializing is permitted in Mission Park, the**
84 **parking lot or the immediate surrounding area. After their match, players**
85 **must promptly drive, ride or walk to their next destination.** Players must
86 proceed directly to their car/cart and drive out of the immediate area to avoid
87 congregation in the pickleball facility or parking lot. Avoid post-play socializing.
88 Thoroughly wash paddles, grips, pickleballs, towels, clothes, bags, water bottles
89 and other items you ~~they~~ have used or touched. [Washing instructions moved up]
- 90 19. A sanitizing bucket will be provided between Bocce and Pickleball courts for
91 cleaning equipment. [Moved up and incorporated with similar references.]

I move to open Mission Park, Stage 1, under the required guidelines and protocols, as presented, for active outdoor activities (Pickleball, beginning Monday, June 29). GRF reserves the exclusive right to close Mission Park without notice for non-compliance to posted guidelines.